



Keypad Bollard- BOLLARD-SINGL-R

TECHNICAL INTRODUCTION



Introduction

WHAT IS THE BOLLARD-SNGL-R

The BOLLARD-SNGL-R is an inground pedestal mount option for the E850M and E850G

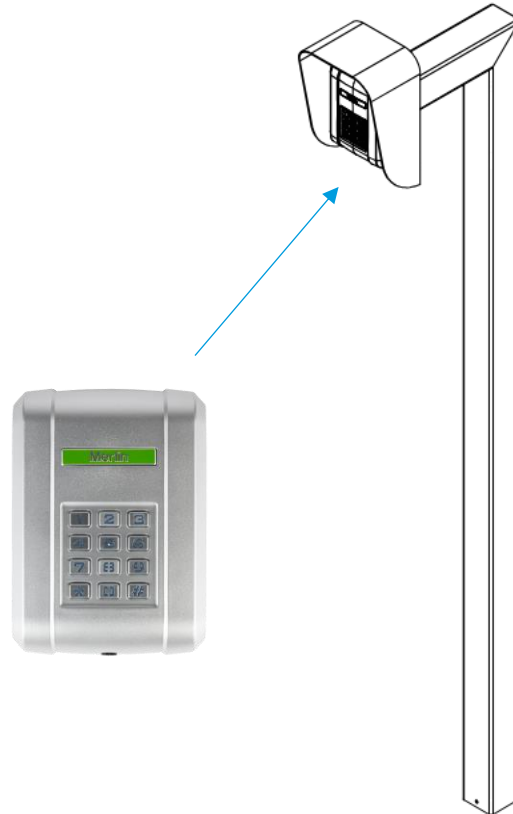



Introduction

WHAT IS THE BOLLARD-SNGL-R

- The Bollard is designed to be installed in-ground, rather than surface mounted.
- Recommended height: 1300mm to 1400mm
- Hole diameter: 200mm wide
- Hole depth: 500mm to 400mm

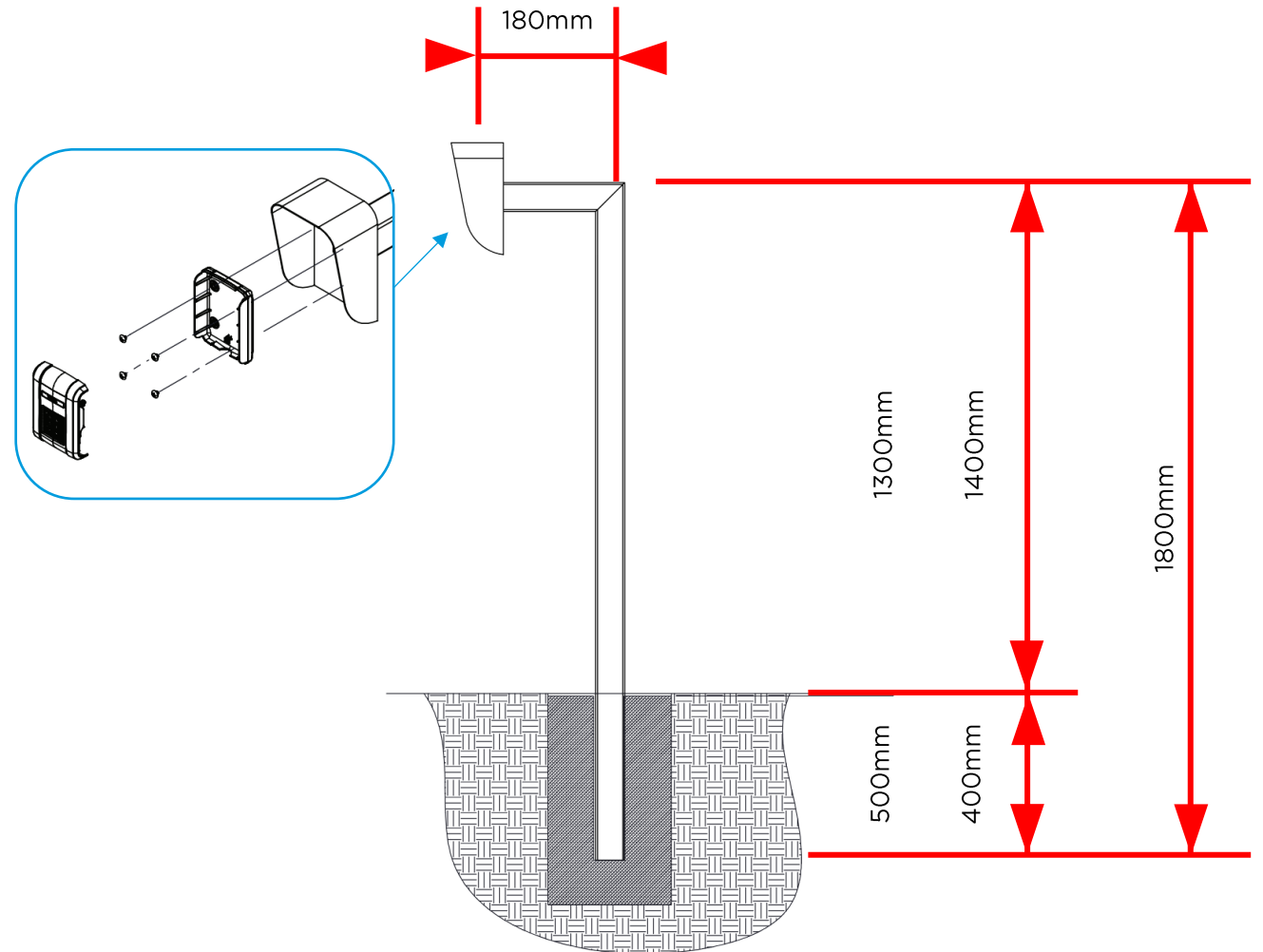



Introduction

SPECIFICATIONS

Material	Steel
Finish	Powder Coated (Black)
Height	1800mm
Offset	180mm
Weight	7.5Kg
Diameter	60mm x 60mm Square Tube
Compatible With	E850M, E850G

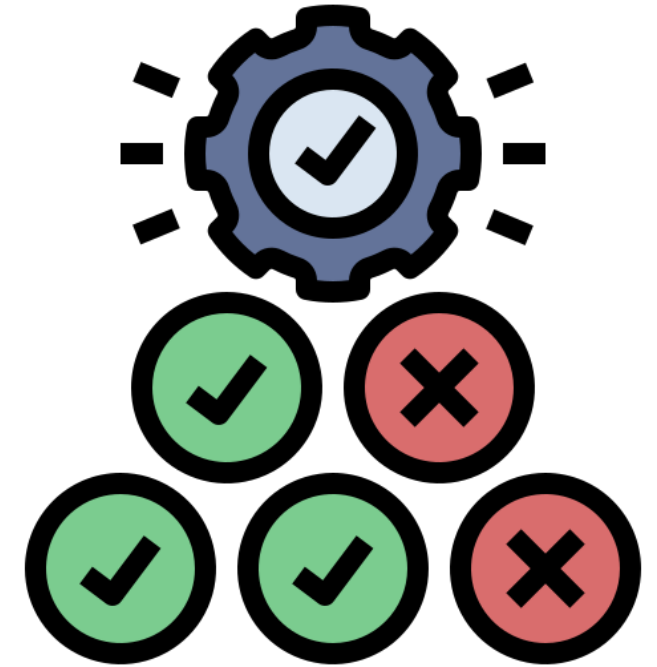

QR CODE LINK
TO MANUAL



QR CODE LINK TO
SHARE THIS
TRAINING MODULE



