

Merlin®

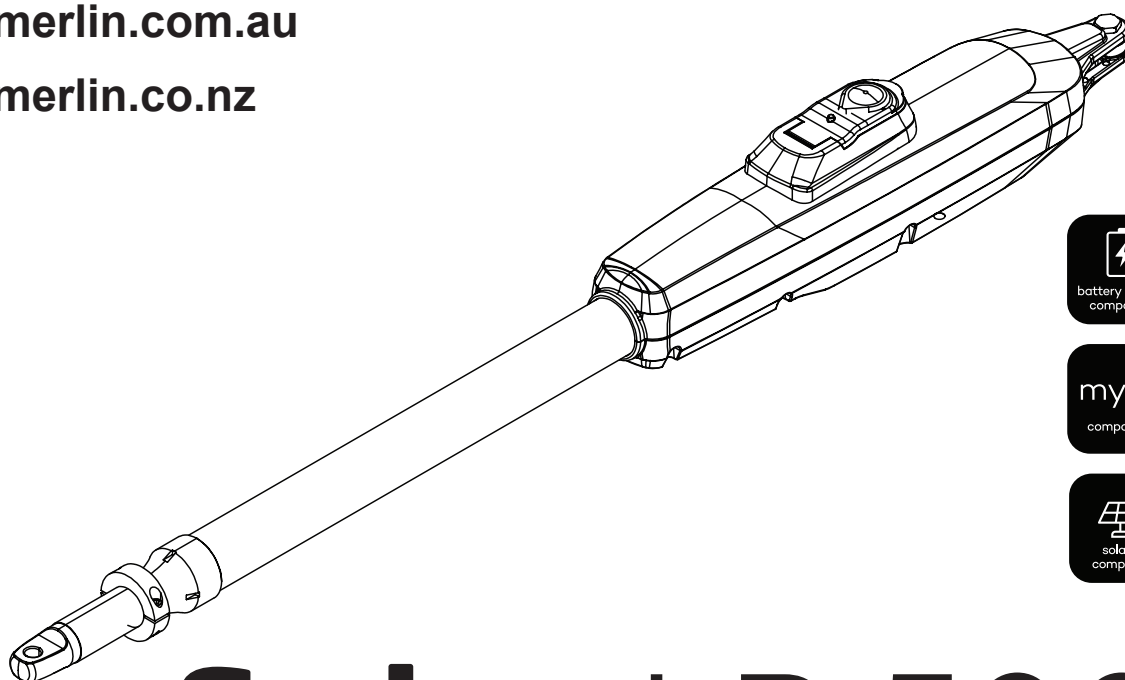

gomerlin.com.au

gomerlin.co.nz



Swing LR 500 MRGLSK

Linear Gate Opener
(MRGLSK-SP / MRGLSK-MP)

Installation and Operating Instructions

Owners Copy: SAVE THESE INSTRUCTIONS for future reference

Visit the Swing LR 500 landing pages for:

- Product features
- Purchase compatible accessories
- Handy tips & how-to videos
- Digital copy of this manual
- Register your warranty

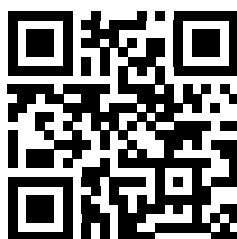

AUSTRALIA

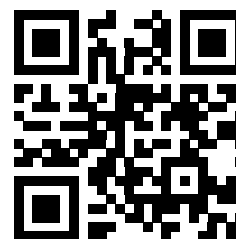

NEW ZEALAND



This manual contains **IMPORTANT SAFETY** information
DO NOT PROCEED WITH THE INSTALLATION BEFORE READING THOROUGHLY



SAFETY INSTRUCTIONS

WARNING!

START BY READING THESE IMPORTANT SAFETY INSTRUCTIONS

- Failure to comply with the following instructions may result in serious personal injury or property damage.
- Read and follow all instructions carefully.
- The gate opener is designed and tested to offer safe service, provided it is installed and operated in strict accordance with the instructions in this manual.

About this Manual

These instructions are the original operating instructions according to the AS/NZS 60335.1 in conjunction with AS/NZS 60335.2.103. The instruction manual must be read carefully to understand important product information. Pay attention to the safety and warning notices.

Keep the instructions in a safe place and make sure that they can be viewed by the user at all times. Keep the manual for future reference and to make it available to all persons for inspection, service, maintenance and repair. After installation pass the complete documentation to the owner.

After installation and programming, all users must be instructed in the function and operation of the gate opener for correct and safe operation.

Before first use and based on the standard requirements the installer must inspect gates regarding their safe condition.

Before you begin the installation:

This product must be installed by a professional installer.



The installer must understand the following:

- The operation of the drive and potential hazards
- The operation of the manual emergency release mechanism
- The regular maintenance, inspection and care according to the Standards
- The installer must instruct other users on the safe operation of the gate opener

Please read the operating instructions and especially the precautions. The following symbols are placed in front of instructions to avoid personal injury or damage to property. Read these instructions carefully.

Warning Symbols

The general warning symbol indicates a danger that can lead to injuries or death. In the text section, the general warning symbols are used as described below.

DANGER Symbol	WARNING Symbol	CAUTION Symbol	ATTENTION Symbol
 DANGER	 WARNING	 CAUTION	ATTENTION
Indicates an imminent hazardous situation which, if not avoided, will result in death or serious injury.	Indicates a potentially hazardous situation which, if not avoided, could result in death or serious injury.	Indicates a potentially hazardous situation which, if not avoided, could result in minor or moderate injury.	Indicates practices not related to personal injury.

Intended Use

The gate opener is exclusively designed and tested for the operation of smooth-running gates.

The maximum permissible gate size and the maximum weight must not be exceeded. The gate must open and close smoothly by hand. Use the opener on gates which comply with the applicable Standards and guidelines. Regional conditions of wind loads must be taken into account when using door or gate panels. Observe the manufacturer's specifications regarding the combination of gate and opener. Possible hazards within the meaning of AS/NZS 60335.1 in conjunction with AS/NZS 60335.2.103 are to be avoided by designing and installing the gate according to the relevant instructions. This gate mechanism must be installed and operated in accordance with the appropriate safety rules.

Improper Use

The construction of the gate opener is not designed for the operation of heavy-duty gates. It is not permitted on gates that travel with incline/decline.

Any improper use of the gate opener could increase the risk of accidents. The manufacturer assumes no liability for such usage. With this gate opener, automated gates must comply with the current, valid local Standards, guidelines and regulations, AS/NZS 60335.1 in conjunction with AS/NZS 60335.2.103.

Only Merlin genuine and approved accessories may be connected to the gate opener. Incorrect installation and/or failure to comply with the following instructions may result in serious personal injury or damage to property.

SAFETY INSTRUCTIONS

During operation, the gate should not under any circumstances obstruct public path ways and roads (public area). When using tools and small parts to install or carry out repair work on a gate, exercise caution and do not wear rings, watches or loose clothing.

To avoid serious personal injury due to entrapments, remove any locking device fitted to the gate in order to prevent damage to the gate.

Installation and wiring must be in compliance with your local building and electrical installation regulations. Power cables must only be connected to a properly earthed supply.

Disconnect electric power to the system before installation, maintenance, repairs or removing covers. A dual pole isolating switch must be provided to the mains power supply (permanently-wired installation) to guarantee all-pole disconnection (isolating switch or by a separate fuse). The repairs and electrical installations may be performed only by an authorized electrician. Emergency Stop Button must be installed for emergency case based on the risk assessment.

Any possible entrapment caused by the moving gate leaf(s) between gate & walls must be eliminated by respecting the given safety distances in accordance with the AS/NZS 60335.1 in conjunction with AS/NZS 60335.2.103 and/or with safety devices (e.g. safe edge).

Testing of the safety function of the drive system is recommended to be carried out at least once a month. Refer also to manufacturers instruction of the gate system components.

After the installation a final test of the full function of the system and the safety devices must be made.

After installation and commissioning, all users must be instructed in the function and operation of the swing gate opener.

It is important to make sure that the gate always runs smoothly. Gates which stick or jam must be repaired immediately. Employ a qualified technician to repair the gate, never attempt to repair it yourself. This device is not intended for use by persons (including children) with restricted physical, sensory or mental abilities or lack of experience or knowledge, unless they are supervised by a person responsible for their safety or have received instruction in how to use the device. If necessary, control equipment MUST be mounted within sight of the gate and out of reach of children. Children should be supervised to ensure that they do not play with the device. Do not allow children to operate push button(s) or remote(s). Misuse of the gate opener system can result in serious injury.



WARNING! Product includes wireless transmitters and wall controls that contain coin/button cell batteries. The Battery is hazardous. Keep wireless devices and batteries away from children. Battery can cause severe or fatal injuries in 2 hours or less if swallowed or placed inside any part of the body. Seek immediate medical attention if it is suspected that a coin/button cell battery has been swallowed or placed inside any part of the body.

- Do not allow children to play with fixed control (control box).
- Keep remote controls away from children;
- Activation of the manual release may cause uncontrolled movement of the driven part due to mechanical failures or an out-of-balance condition;
- Frequently examine the installation for imbalance where applicable and signs of wear or damage to cables, springs and mounting.
- Do not use if repair or adjustment is necessary; Disconnect the supply(s) when cleaning or other maintenance is being carried out.
- **WARNING:** Important safety instructions. Follow all instructions since incorrect installation can lead to severe injury.
- The installer shall check that the temperature range marked on the drive is suitable for the location.
- Before installing the drive, check that the driven part is in good mechanical condition, opens and closes properly and correctly balanced where applicable;
- Ensure that entrapment between the driven part and the surrounding fixed parts due to the opening movement of the driven part is avoided.
- After installation, ensure that the mechanism is properly adjusted and that the protection system and any manual release function correctly;
- Permanently fix the label concerning the manual release, adjacent to its actuating member.

CONTENTS

SAFETY INSTRUCTIONS	2-3
INTRODUCTION	5-10
Specifications	5
Sales Kit Inventory	6
Additional Sales Kit Inventory with MRGLSK-SP Swing LR 500 Gate Opener Solar Power Kit.....	7
Planning.....	8
Tools Needed	9
Overview of Gate Installation and Warning Label.....	9
Overview of Gate Installation and Warning Label - Solar Power Kit	10
INSTALLATION.....	11-13
Post Bracket Installation.....	11
Gate Arm Installation.....	11
Disengagement of the Manual Release	12
Install the Control Box.....	12
Install the Transformer Box	13
WIRING	13
Electrical Safety.....	13
Motor Connection	13
ACCESSORIES	14
E-LOCK Installation and Connection	14
Safety Beams	14
PROGRAMMING	15-17
LCD Screen Menu.....	15
Programming Overview.....	15
Initial Setup.....	16
Limit and Force Learning	17
BASIC SETTINGS.....	17-22
Remote Control Behaviour	17
IR Behaviour.....	18
Command Input.....	18
Pedestrian Command.....	19
Timer To Close (TTC)	19
Reversal Time	20
E-LOCK	20
Ram Blow for E-LOCK	21
Flashing Light.....	21
Flashing Light - Pre-Flashing	21
Special Contact	21
Soft Start Duration in Open and Close Direction	22
Maintenance Counter	22
FACTORY RESET.....	23
WIRELESS PROGRAMMING	24-27
Remote Control Programming.....	24
MyQ Set-up	25-27
OPERATION AND MAINTENANCE.....	28-30
Error Codes	28-30
Accessories	30
PROGRAMMING FLOW CHART	31-34
CHAMBERLAIN LIMITED WARRANTY	35-36

INTRODUCTION

1 SPECIFICATIONS – SWING LR 500

Main AC Supply:	220-240 Vac; 50-60 Hz (when 120VA Mains Power Kit is used)
Motor Voltage:	24 Vdc
Input Power (single arm):	50 W
Ambient Temperature Range:	-20 ~ +55°C
Maximum Weight for single Gate:	300 kg/3 m, 250 kg/4 m, 200 kg/5 m
Maximum Width for single Gate	5 m
Maximum Pull Force:	1500 N
Maximum Open Angle:	120°
Running Time:	5 minutes
Ingress Protection:	IP 44 (Gate Opener), IP 65 (Control Box) Suitable for outdoor installation
Transmitter Frequency:	433.30 MHz/ 433.92 MHz/ 434.54 MHz
Memory registers:	64 handset codes (max. 4 keypad devices - 1 code each.)

Dimensions - Gate Opener

Gate Opener Height:	137 mm
Gate Opener Width:	835 mm
Gate Opener Depth:	95 mm
Gate Opener Weight:	6 kg

Dimensions - Control Box/Transformer Box

Gate Opener Height:	300 mm
Gate Opener Width:	230 mm
Gate Opener Depth:	140 mm
Transformer Box Weight:	4.6 kg
Control Box Weight:	2.5 kg

INTRODUCTION

2 SALES KIT INVENTORY

Your gate opener is packed in separate cartons. Subject to if you have purchased the Swing LR 500 with the Solar Kit or the Mains Power Kit, the supplied items will differ.

- The Swing LR 500 MRGLSK-MP gate opener sales kit contains the opener, its hardware, a control box, a Main Power Kit transformer box (MRGTR3-120VA) and accessories.
- The Swing LR 500 MRGLSK-SP gate opener sales kit contains the opener, its hardware, a control box, a Solar Power Supply Enclosure (SOLAR-PSE), a 40W Solar Panel (SP40W), a Solar Panel Mount Kit (SP-MOUNT-KIT) and accessories.

- | | |
|--|---------------------------------------|
| 1. Opener with 1.5m pre-wired cable and connector | 7. Post Bracket |
| 2. Control Box with pre-wired connections | 8. Post Bracket arm |
| 3. Mains Power Kit (MRGTR3-120VA) with 1.5m Power Cord and 4m pre-wired cable with connector (supplied with the MRGLSK-MP Swing LR 500 Gate Opener 240V Mains Power Kit) | 9. 3 x M10 x 30 Bolts washer and nuts |
| 4. 2 x Four Button Remotes (E975M) | 10. 4 x Gate clamp assembly |
| 5. Installation Manual | 11. Gate flat bracket |
| 6. 2 x Release Keys | 12. 2 x Clevis Pin |
| | 13. Gate bracket |
| | 14. 2 x Hair pin clip |

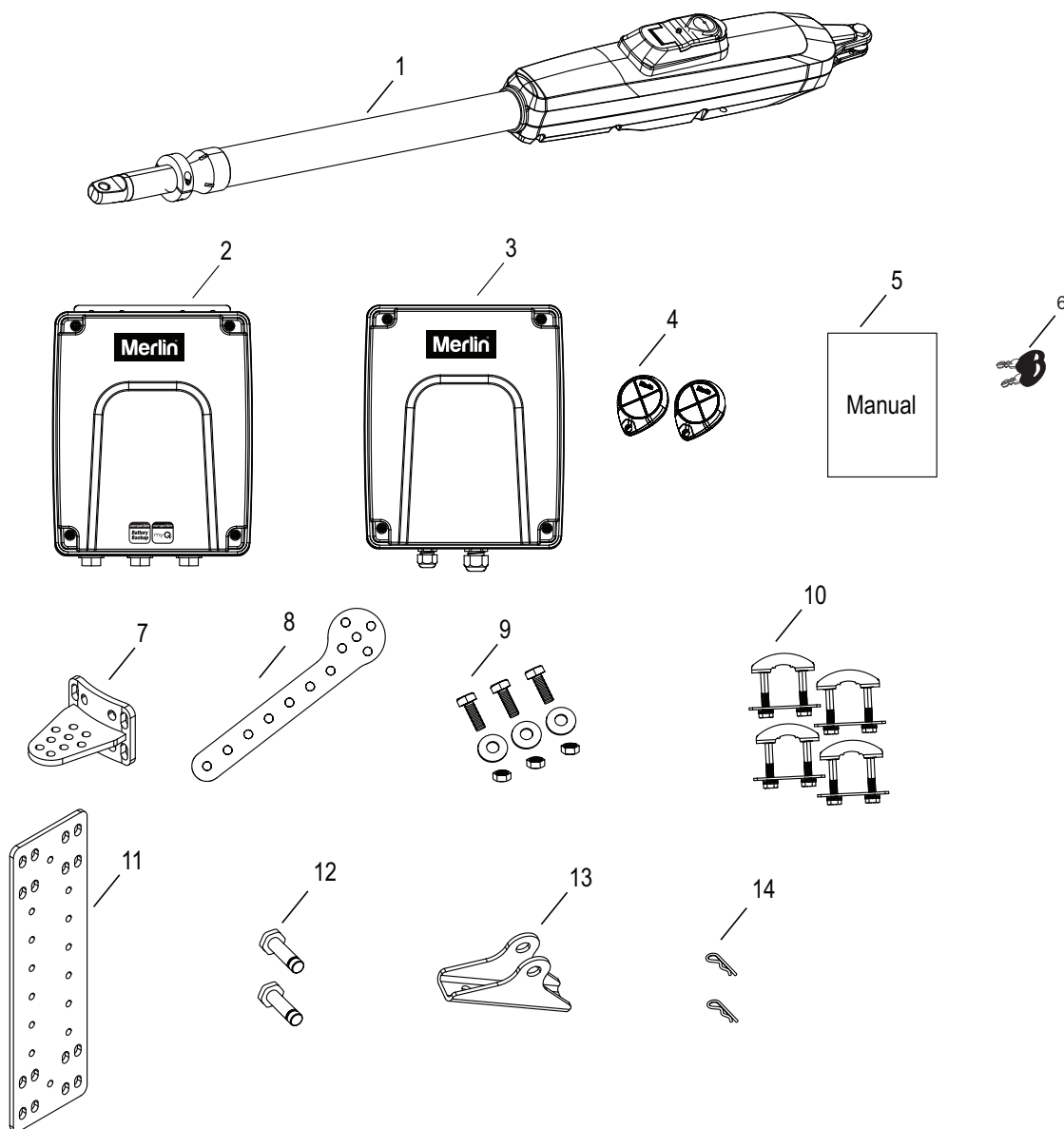

INTRODUCTION

2 ADDITIONAL SALES KIT INVENTORY (WITH MRGLSK-SP SWING LR 500 GATE OPENER SOLAR POWER KIT)

1. Solar power supply enclosure (Inc batteries)
2. Solar power supply enclosure mounting bracket
3. 240V Mains power pack with battery charge plug with adaptor cable
4. Solar Power Kit to Gate Opener power cable (4m)
5. Solar panel with cable (4m) (included with SKU number SP40W)
6. Solar Panel mounting bracket (included with SKU number SP-MOUNT-KIT)
7. Mounting bracket base plate (included with SKU number SP-MOUNT-KIT)
8. Solar Panel mounting hardware (included with SKU number SP-MOUNT-KIT):
 - 1pc X hexagonal socket spanner
 - 1pc X hexagonal socket Driver Bit
 - 4pcs X M6 nuts
 - 12pcs X M6*10 anti-tamper screws
9. Manual

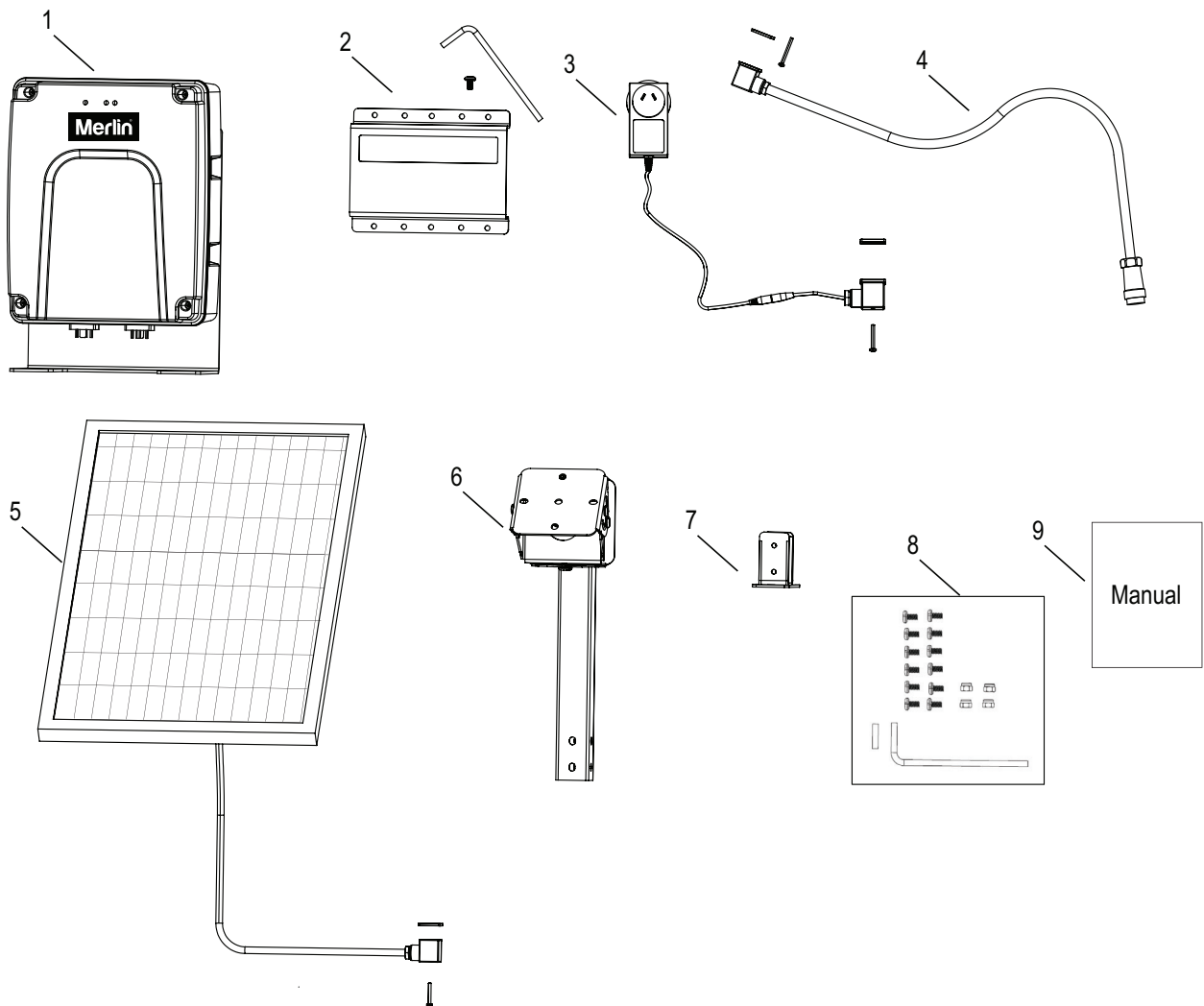

INTRODUCTION



Before installing the gate opener, ensure that the gate is opening smoothly. Determine the dimensions based on the opening angle provided in Table 1 (below) to confirm the position where the post bracket will be mounted. Ensure that all the required cables (power cable, accessory cables etc) are prepared and laid correctly.

NOTE: All crushing points must be secured by suitable entrapment protection devices as per the requirements in AS/NZS 60335.2.103. It is the responsibility of the installer to ensure compliance of the final installation, and every installation must be checked for compliance by the installer.

3 PLANNING

Wind Load Rating for Swing Gate Operators

We do not have wind load ratings on our gate openers, as Chamberlain is not responsible for how gate installers design their gates.

Recommendations

- Do not use a solid leaf/panel gate in windy areas.
- Use a light weight picketed swing gate to minimize the wind force.
- The optional ELOCK-R can be installed to keep the gate securely shut.

NOTE - The E-LOCK for Rural Gates (ELOCK-R) does not function when the Swing LR 500 gate opener is powered by the optional Battery Backup (MGBBU). Manual release of the lock is required to open the gate if operated under Battery Backup power.

Alternative E-LOCKS which operate under Battery Backup Power: ELOCK-H (E-LOCK for Horizontal Installation) and ELOCK-V (E-LOCK for Vertical Installation).

- It may be needed to hold the gate(s) open or close, in windy applications.
- When selecting an opener, be sure to select the correct opener for the size of gate.
- Do not use any chains or ropes to keep that gate shut while the opener is in use.

Power Wiring

1. All wiring is Plug and Play using pre-wired connectors.
2. If using the Transformer Box, a 240V mains power supply must be installed near the transformer box installation location.
3. If using the SOLAR-KIT, the Transformer Box is not used (for wiring of the Solar Kit, please refer to the SOLAR-KIT manual).
4. The 240V Transformer box (MRGTR3-120VA) is supplied with a 1.5m long mains power cable with plug and a 4m prewired cable to connect to the Control Box.
5. The Control Box will require a low-voltage power supply from the Main Power Kit (MRGTR3-120VA) or the Solar Kit (SOLAR-KIT).

Installation Recommendations

1. Use Table 1 below to determine the opening angle required and the appropriate A and B dimensions required.
2. For optimal mechanical advantage, A and B dimension shall be equal or close. The difference between A and B should be no greater than 460mm.
3. The ideal A & B sizes are 220 x 220

NOTE: Smaller A and B dimensions determine larger opening angle and an increase in gate speed. A longer gate will have a higher speed and force on the leading edge of the gate arm.

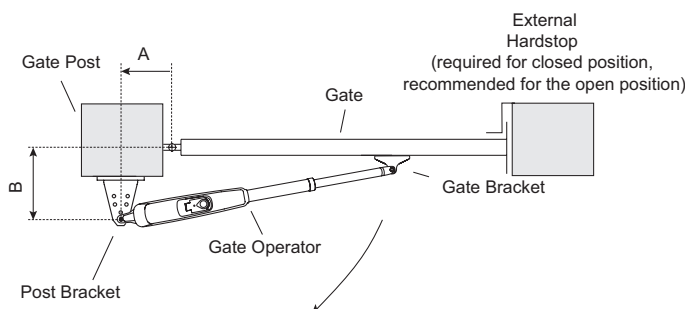

		Dimension A				
		mm	180	200	220	240
B	180	X	120 ⁰	110 ⁰	100 ⁰	90 ⁰
	200	120 ⁰	120 ⁰	110 ⁰	100 ⁰	90 ⁰
	220	110 ⁰	110 ⁰	110 ⁰	100 ⁰	X
	240	100 ⁰	110 ⁰	100 ⁰	90 ⁰	X
	260	90 ⁰	90 ⁰	90 ⁰	X	X

Note: The ideal A & B sizes are 220 x 220. If different sizes are used, the sum of A & B should not be greater than 460.

The unit should be installed in a suitable location to allow for connection with the power cables provided.

INTRODUCTION

4 TOOLS NEEDED

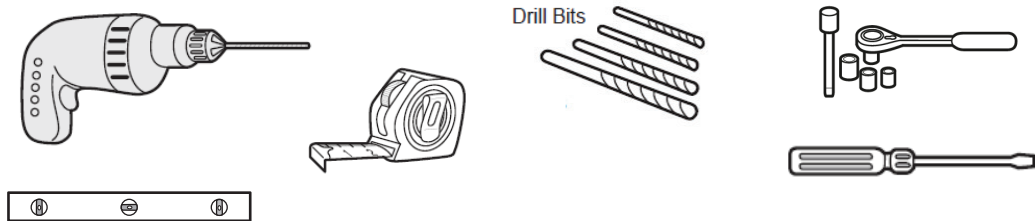

5 OVERVIEW OF THE GATE INSTALLATION AND WARNING LABEL

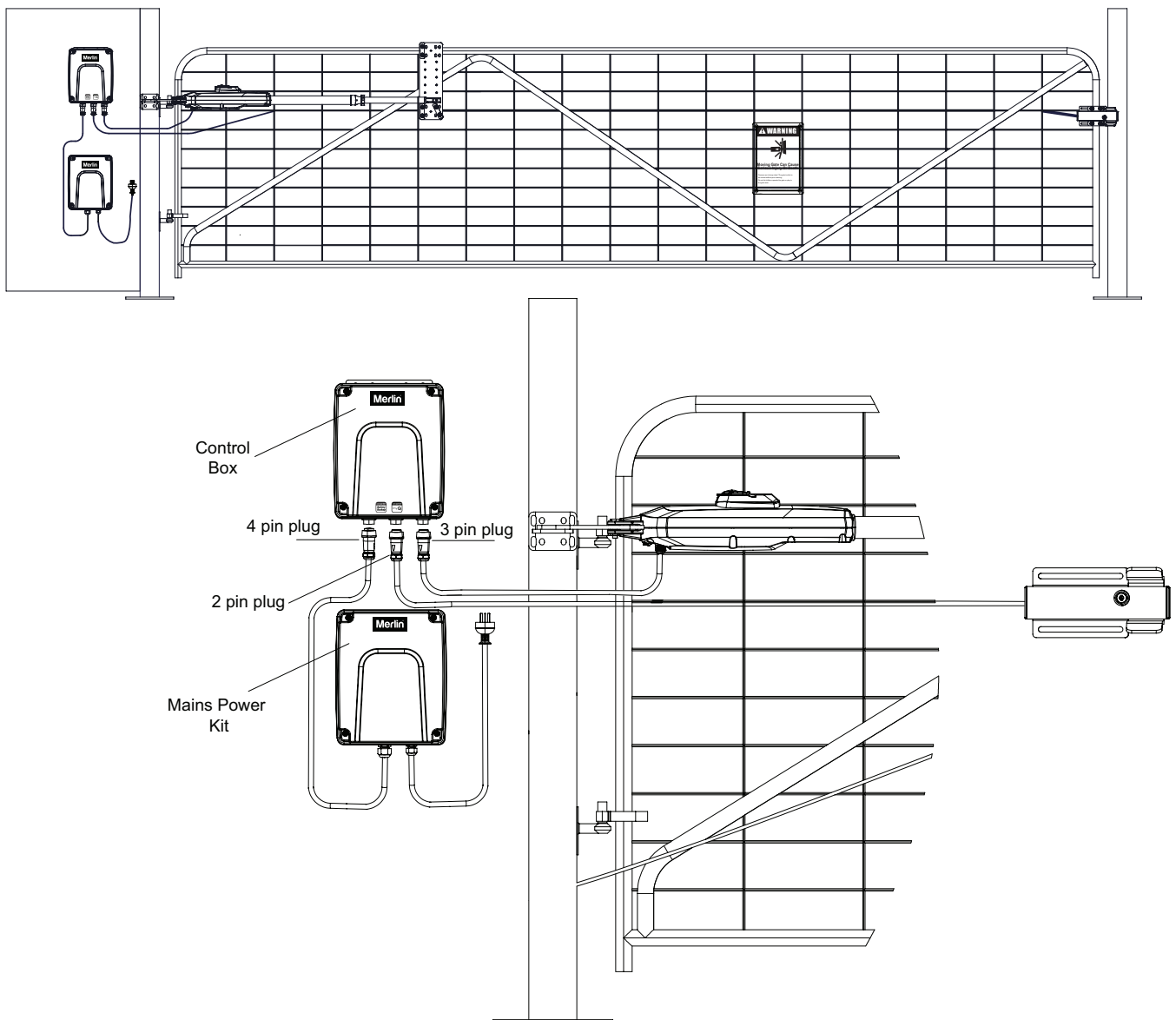

INTRODUCTION

5 OVERVIEW OF THE GATE INSTALLATION AND WARNING LABEL - SOLAR POWER KIT

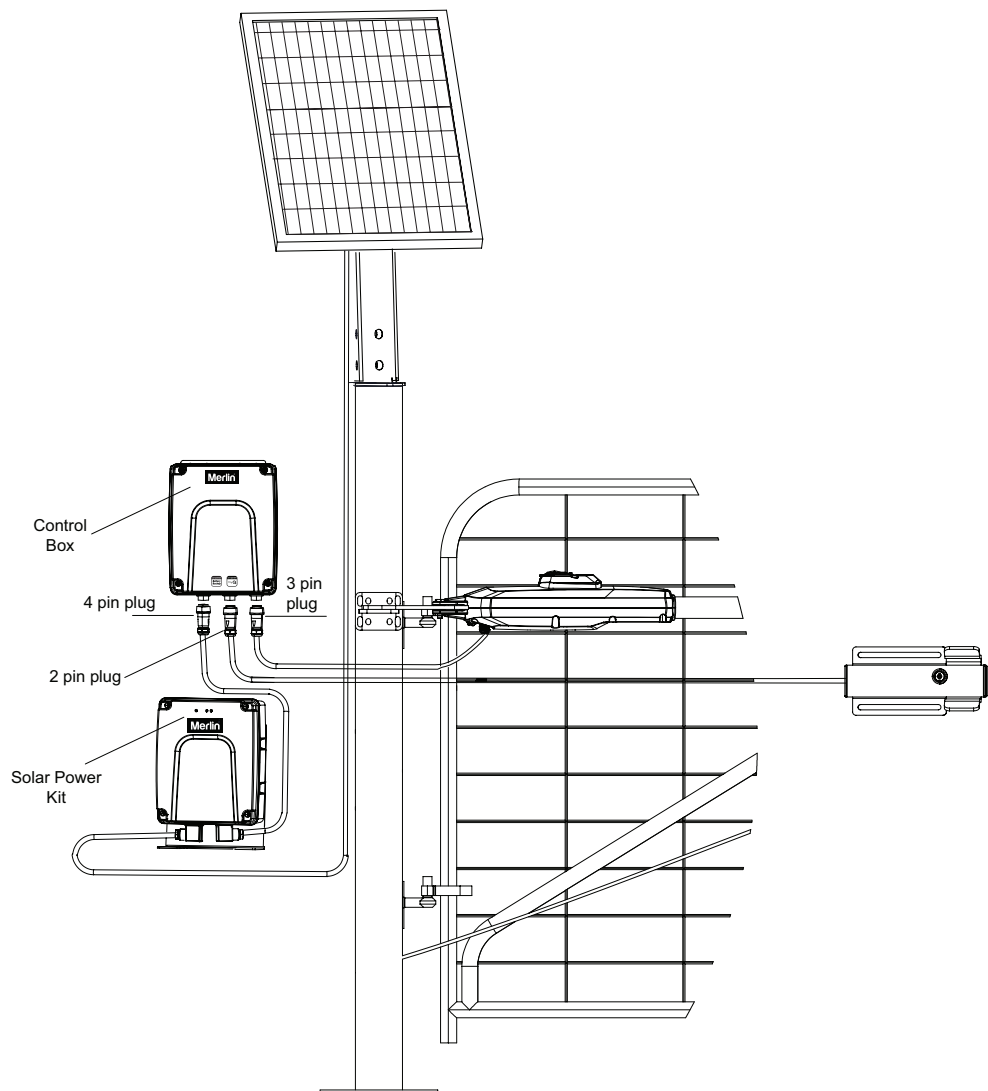
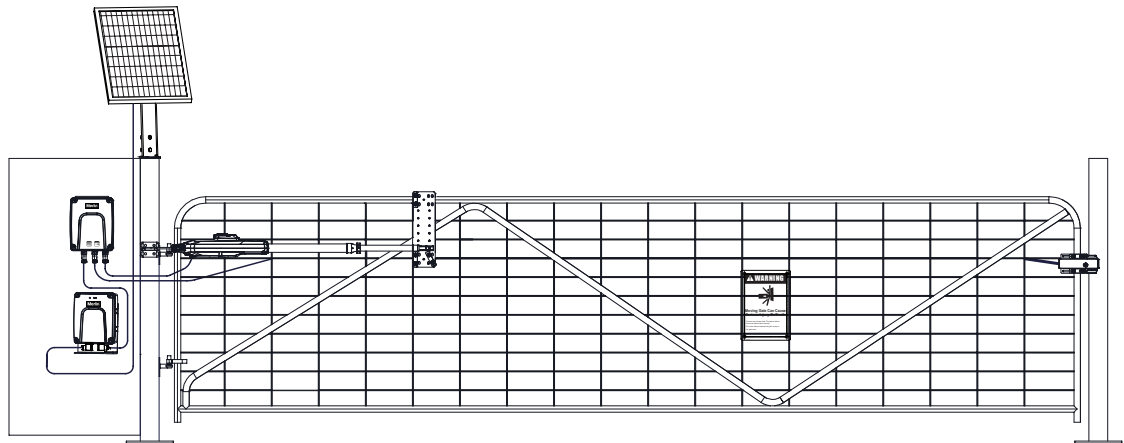

INSTALLATION

6 POST BRACKET INSTALLATION

1. Using the post bracket as a reference, mark and drill the holes for the post bracket.
2. Attach the post bracket to the post using appropriate fixings.
3. The slots on the post bracket allow for alignment.
4. The Post Arm Bracket may be required to achieve the correct A and B Dimensions (as per Geometry Planning).
5. Use the supplied M10 bolts (x2) to attach the Post Arm bracket to the Post Bracket. The holes allow for multiple positions. The Post Arm Bracket length can be cut to length if required.

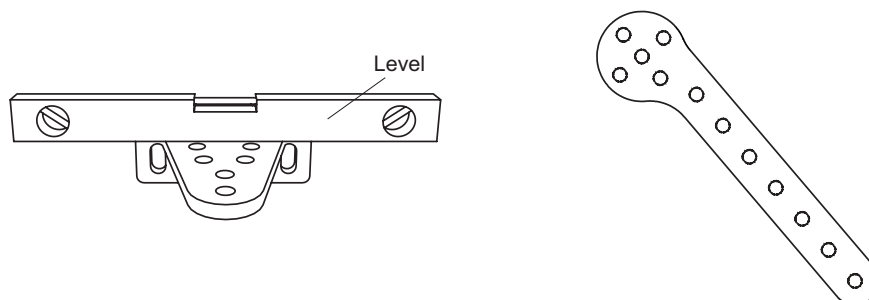

7 GATE ARM INSTALLATION

1. Bring gate to the "closed" position.
2. Attach the opener to the assembled post bracket using the clevis pin and secure with a hairpin clip.
3. Using the Manual Release, disengage the opener (see section 8) and pull the tube out to the fully extended position.
4. Install the gate arm bracket onto the arm and attach with the supplied clevis pin and hairpin clip
5. Position the gate flat bracket to align with the structural beams of the gate and the gate arm bracket attached to the gate arm.
6. Using the clamps provided, attach the gate flat bracket to the gate structural members
7. Using the supplied M10 bolts, attach the gate bracket to the gate flat bracket.
8. Manually open the gate to the required position. Adjust the stop collar on the gate arm cylinder to the desired open position. The stop collar fixing screws should be torqued to between 21Nm and 24Nm. If the stop collar is not used you will need to install an external hard stop to stop the gate in the desired open position. The stroke of the gate arm should not be used for the open position.

NOTE: Be sure that during the manual movement from close to open and vice versa, there is no obstruction or impact of the arm against the leaf or pillar.

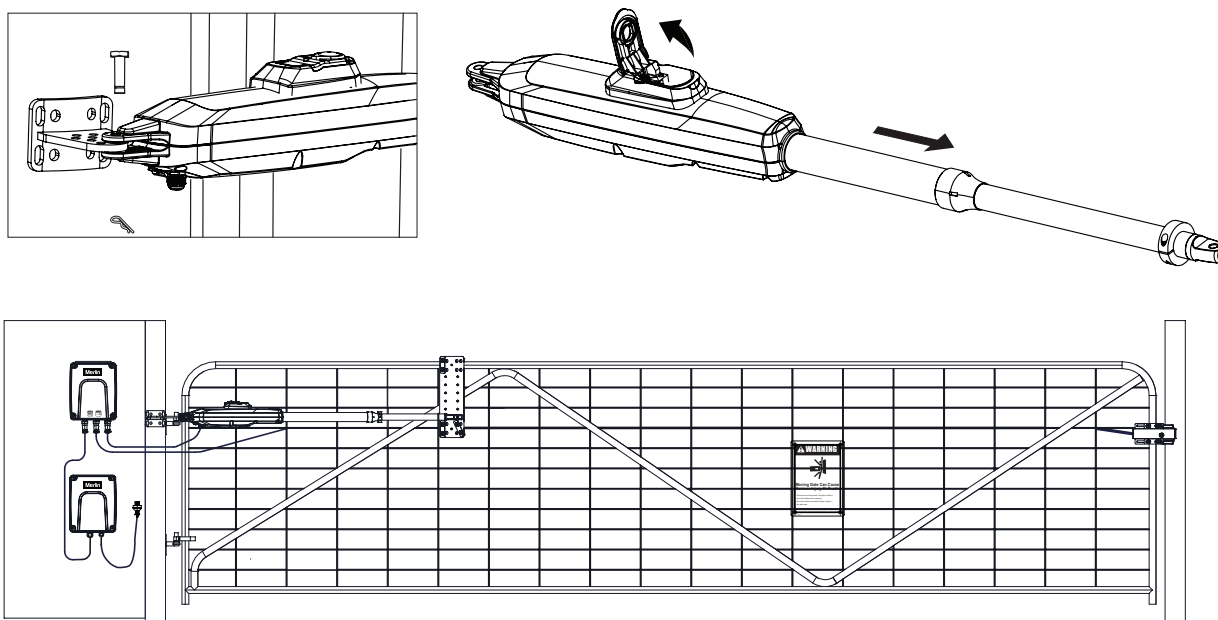

INSTALLATION

8 DISENGAGEMENT OF THE MANUAL RELEASE

1. Rotate key shield to expose keyhole
2. Put the key into the keyhole and turn
3. Lift the lever up

NOTE: to re-engage the opener, follow the procedure in reverse

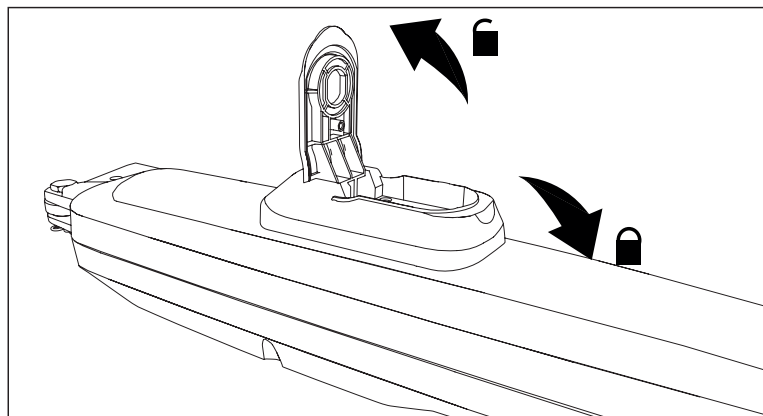

9 INSTALL THE CONTROL BOX

The control box must be installed at a safe location that enables the installer to have access at all times to the logic board without the risk of the gates crushing or trapping.

It is advised that you must have full view of the gates when programming the logic board.
Install the control box in an appropriate and accessible position.

1. Attach the Control Box mounting bracket to the post within a metre of the gate arm.
2. Clip the Control box onto the mounting bracket and secure with the security screw.

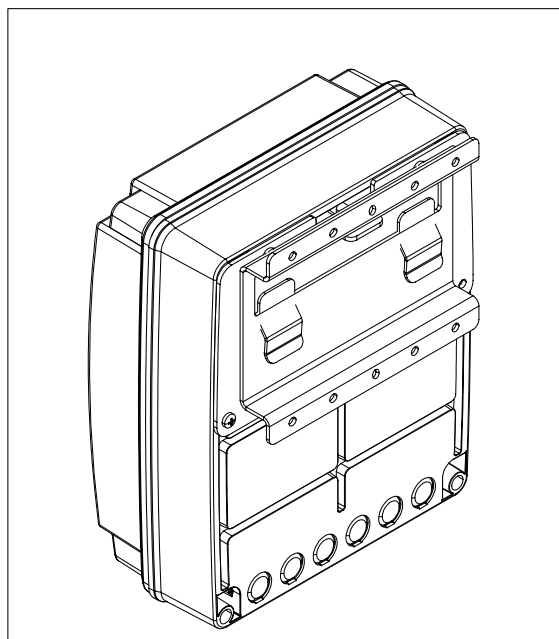
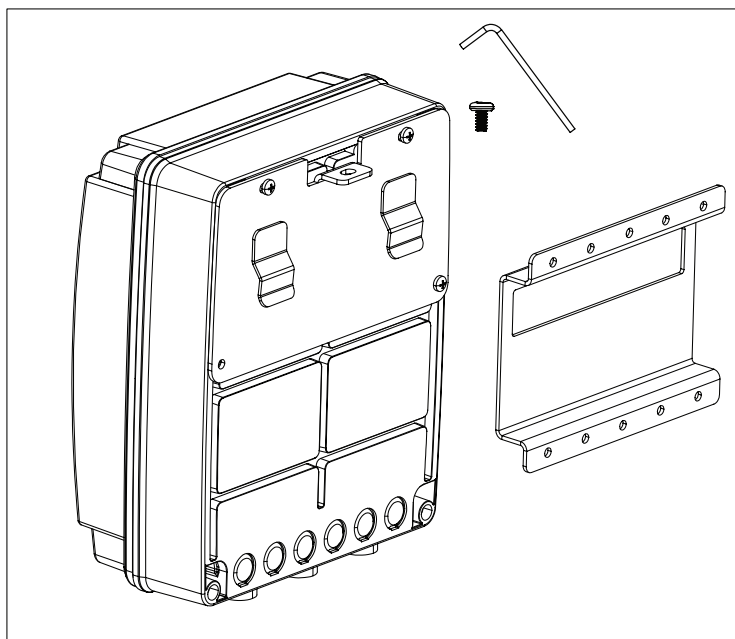

INSTALLATION

10 INSTALL THE TRANSFORMER BOX

Supplied as part of the Swing LR 500 Gate Opener Main Power Kit (MRGLSK-MP).

If the Swing LR 500 Gate Opener Solar Power Kit (MRGLSK-SP) has been supplied, please refer to Solar Kit (SOLAR-KIT) manual for installation instructions.

1. Using the fixed post bracket as a reference, mark and drill the holes for the post bracket.
2. Attach the fixed post bracket to the post using appropriate fixings.
3. Lift the enclosure onto the slot in the post bracket.
4. Secure the enclosure onto the post bracket with the security screw and tool provided.

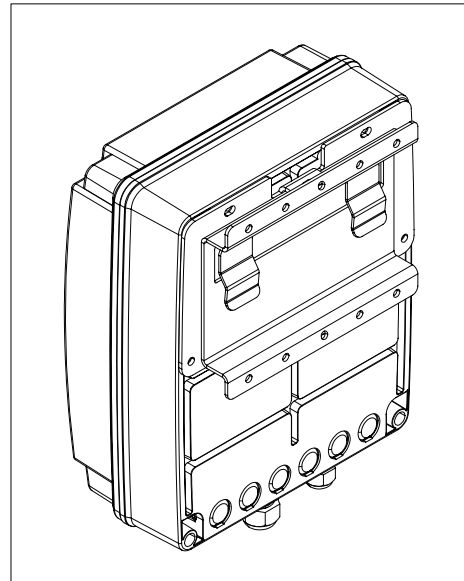
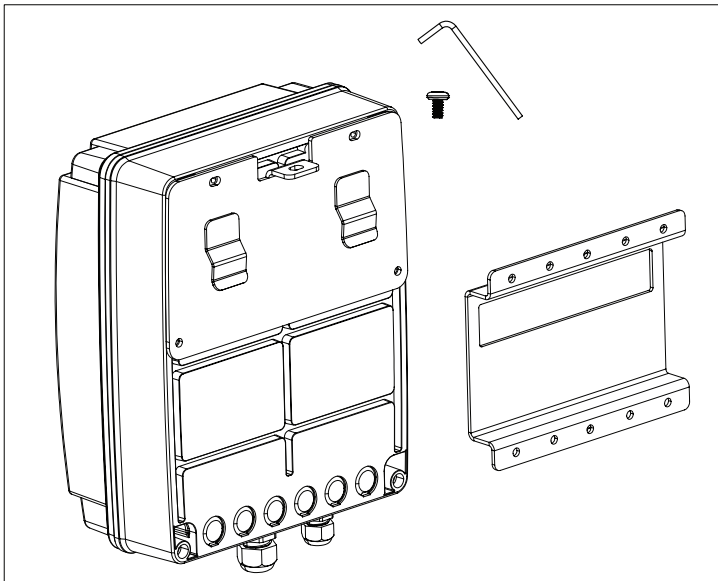

WIRING

11 ELECTRICAL SAFETY



To reduce the risk of SEVERE INJURY or DEATH:

- Follow all connection instructions as per the details provided within this manual.
- Failure to do so may result in SEVERE INJURY to persons and/or damage to the opener.

If AC power is required:

- ALL electrical connections MUST be made by a licensed electrician as per local standards.
- Power to the control box must be isolated prior to performing any electrical connections.
- Power to the control box must be isolated prior to performing ANY maintenance on the gate, opener, or within the gate movement area.
- Before re-energizing the control box, make sure the area around the gate's movement path is clear of any obstructions or personnel.

WIRING

12 MOTOR CONNECTION

1. Connect the pre-wired 3-pin connector from the gate arm to the 3-pin socket on the control box.
2. Connect the pre-wired 4-pin connector from the Mains Power Kit (MGRTR3-120VA) Transformer Box or the Solar Kit (SOLAR-KIT) to the 4-pin socket on the Control Box.
3. Connect the 3-pin mains plug to the main power point and turn the power point ON to energise the system.

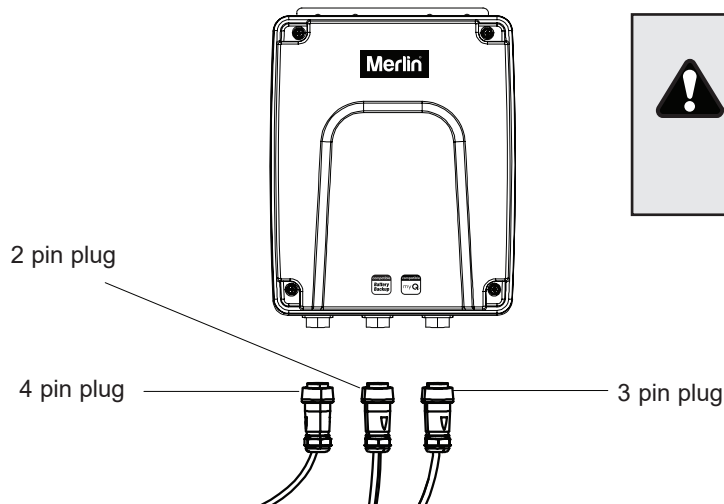

Please remove the PCB from the enclosure before making any penetrations. Damage to the PCB during installation is not covered by warranty

13 E-LOCK INSTALLATION AND CONNECTION

The E-LOCK (ELOCK-R optional, recommended accessory) uses a mechanical lock to hold a gate in the closed position.

- Plug and play connection to the control box.
 - The lock is released with a 24V pulse signal or, in the event of power loss, by using the supplied key to manually release the lock.
 - They are ideal for additional security, but also to limit gate movement.
1. Connect the pre-wired 2-pin connector from the ELOCK-R to the 2-pin socket on the control box.
 2. The ELOCK-R will function automatically when connected. For ELOCK-R adjustment settings refer to section 25.

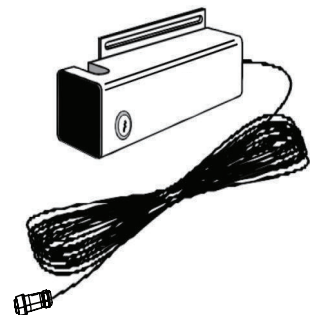

NOTE - The E-LOCK for Rural Gates (ELOCK-R) does not function when the Swing LR 500 gate opener is powered by the optional Battery Backup (MGBBU). Manual release of the lock is required to open the gate if operated under Battery Backup power.

Alternative E-LOCKS which operate under Battery Backup Power: ELOCK-H (E-LOCK for Horizontal Installation) and ELOCK-V (E-LOCK for Vertical Installation).

14 SAFETY BEAMS

THE PROTECTOR SYSTEM (IR BEAMS) (OPTIONAL)

NOTE: Merlin strongly recommends that The Protector System (IR Beams) and/or Safety Bump Edge Sensors be installed on all gate openers.

Compatible Protector System (IR Beams) are 772ANZ and HPS15 Monitored Safety Beams.

The Protector System (IR Beams) can be configured to function differently when connected to IR1, IR2 or IR3 inputs.

1. Connect the Protector System (IR Beams) to IR1/GND or IR2/GND and or IR3/GND.
2. The IR Beams can be configured to monitor in the open, close or both open and close directions (see IR Behaviour section).
3. The IR Beams will automatically learn to the opener after they have been connected and monitor the close direction by default.
4. If you need to remove the IRs, you will need to unlearn them from the opener. This is done by switching power off and on three times.

PROGRAMMING

15 LCD SCREEN MENU

The Control Box contains the four Programming buttons and the LCD Screen used to program the opener and display the status of the opener.

Button	Function
S	<ul style="list-style-type: none"> Program / delete remote controls Specific function during Programming
P	<ul style="list-style-type: none"> Enter programming Mode, Select function and Save the setting. <p>NOTE: long press of P button will save the setting and exit out to the menu screen.</p>
+/-	<ul style="list-style-type: none"> Navigate the menu Change setting values

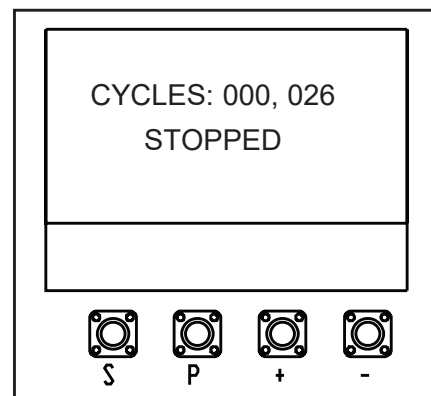

16 OVERVIEW

Legend	Function	Section
Application	Opener Motor Type	16
Direction Motor 1	Direction Motor 1	16
Limit & Force Learn	Learning	17
Remote Control Behaviour	Adjust the behaviour of remote controls	18
IR1-Behaviour	Adjust the behaviour of Protector System Safety IR Beams in input IR 1	19
IR2-Behaviour	Adjust the behaviour of Protector System Safety IR Beams in input IR 2	19
IR3-Behaviour	Adjust the behaviour of Protector System Safety IR Beams in input IR 3	19
Input 1	Adjust the behaviour of Input 1 command	20
Input 2	Adjust the behaviour of Input 2 command	20
Input 3	Adjust the behaviour of Input 3 command	20
Pedestrian	Setup pedestrian opening mode	21
Timer-To-Close	Setup timer-to-close feature	22
Reversal Time	Reversal time after obstruction has been detected	23
E-Lock	E-Lock	24
Ram-Blow	Setup additional electronic lock (E-Lock) or Mag-Lock options	25
Flashing Light	Setup flashing light accessory	26
Pre Flashing	Adjust pre flashing of flashing light accessory	27
Special Contact Relay	Adjust how the special contact input will behave	28
Soft & Hard Start Setting	Disable or enable the soft & hard starts	29
Maintenance Counter	Setup maintenance counter for service alerts	30
Factory Reset	Reset opener	31
Finish and Exit	Complete and exit screen	N/A

17 INITIAL SETUP

Release the opener manual release with the key, and move the gate to a mid open position. Re-engage the manual release. Energise the opener.

The LCD screen will display the Begin Setup.

1. Press and hold the **P** button for approximately 5 seconds to enter into the Main Menu. **MAIN MENU SELECT APPLICATION** will be displayed on the LCD.
2. Press the **P** button once to enter this Menu option.
3. Press **P** again to select LINEAR ARM SINGLE
4. Press the **+** button once to scroll to the next menu option. **MAIN MENU DIRECTION MOTOR1** will be displayed on the LCD.
5. Press the “P” button to select. The screen will change to show **PRESS & HOLD “+” GATE OPENING? YES “P”, NO “S”**.
6. Press and hold “+”. The gate will start to move.
 - a) If it moves in the OPEN direction, press “P” to confirm. The screen will change to show **MAIN MENU DIRECTION MOTOR1**
 - b) If the gate moves in the CLOSE direction, press “S” to confirm. The screen will change to **EXECUTE MOTOR DIRECTION CHANGE**. Press “P” to confirm. Once the direction has been confirmed, the screen will change to **MAIN MENU DIRECTION MOTOR1**. Press the “+” button once to scroll to the next menu option. “**MAIN MENU LIMIT&FORCE LEARN**” will be displayed on the LCD.
7. Press the “P” button to select. *The gate will start to move.* The screen will change and **LIMIT&FORCE LEARN** will flash on the screen.
8. Once complete, the gate will stop moving and the screen will change to **CYCLES: 000,000 STANDBY GATE CLOSED**.

Initial setup is now complete. The opener will now operate using default Basic Settings.

NOTE: If the **LIMIT&FORCE LEARN** setup needs to be stopped, press the “S” button. The Screen will display **LIMIT&FORCE LEARN INTERRUPTED**. After 5 seconds, the screen will display **LIMIT&FORCE LEARN**. Repeat step 8 to complete basic setup.

figure 1

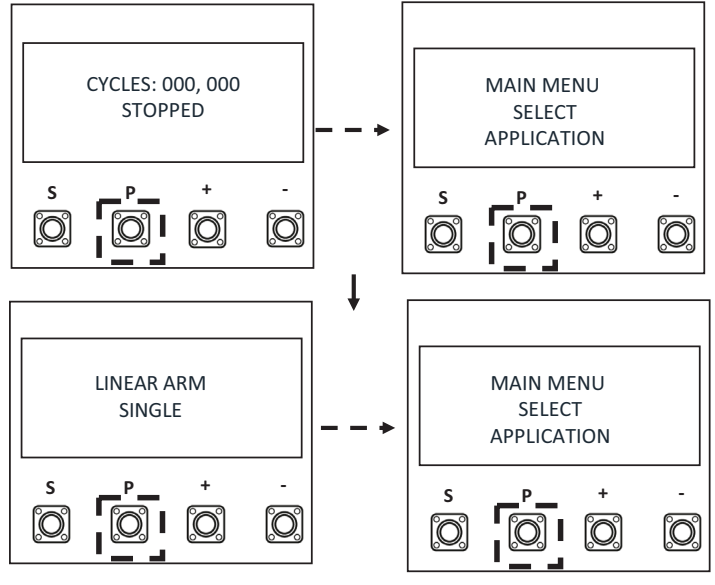

figure 2

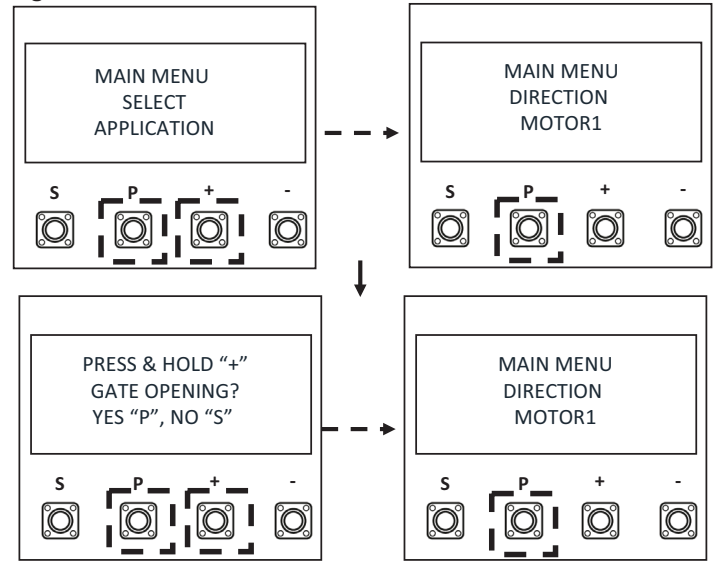
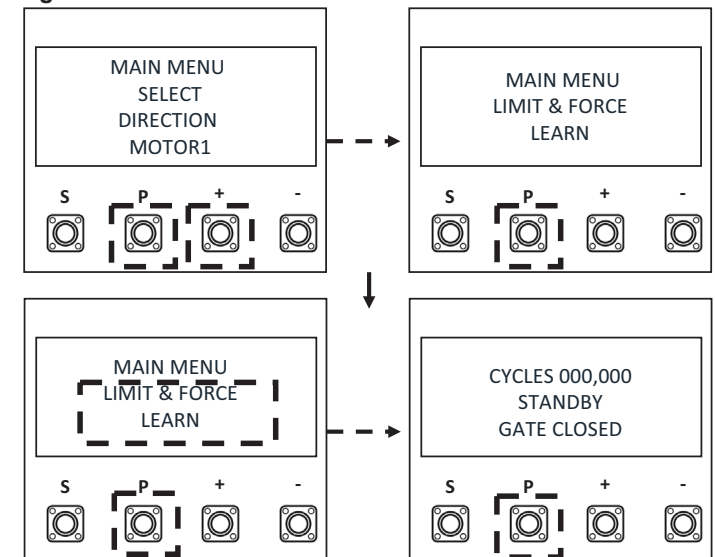

figure 3



PROGRAMMING

18 LIMIT AND FORCE LEARNING

Press and hold the “P” Button to enter Program Mode. Use the + or - button to navigate through the menu screen until you find “MAIN MENU LIMIT & FORCE LEARN”

1. Press the “P” button to enter this setting (figure1).
2. The menu screen will begin flashing “LIMIT & FORCE LEARN” while this sequence is in progress and *the gate will start to move.*
3. Three seconds after successfully completing the “LIMIT & FORCE LEARN” setup, the display will return to the main menu in standby mode.

Note: If the LIMIT & FORCE LEARN setup needs to be stopped, press “S” button. The screen will display “LIMIT & FORCE LEARN INTERRUPTED” (figure 2). After 5 seconds, the screen will display “LIMIT & FORCE LEARN”.

figure 1

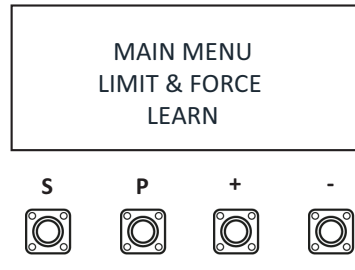

figure 2

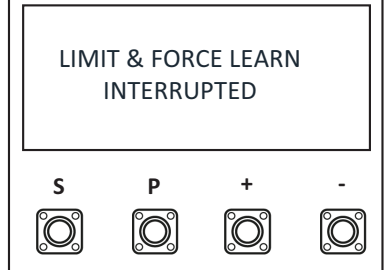
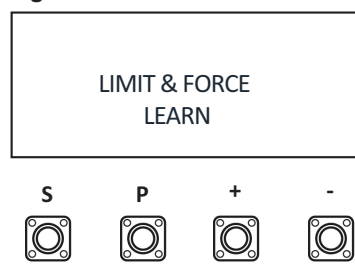

figure 3



BASIC SETTINGS

19 REMOTE CONTROL BEHAVIOUR

This option will program the gate behaviour with each press of the remote control button. Default setting is OPEN-STOP-CLOSE-STOP.

Press and hold the “P” Button to enter Program Mode.

Use the + or -button to navigate through the menu screen until you find “MAIN MENU REMOTE CONTROL BEHAVIOUR”.

1. Press the “P” button to enter this setting.
2. Press the “+” or “-” buttons to navigate through the options.
3. You can select the following options:
 - OPEN-CLOSE-OPEN
 - OPEN-STOP-CLOSE-STOP
 - OPEN-STOP-CLOSE-OPEN
 - OPEN ONLY
4. To confirm the setting, press the “P” button to save and return to the main menu screen.

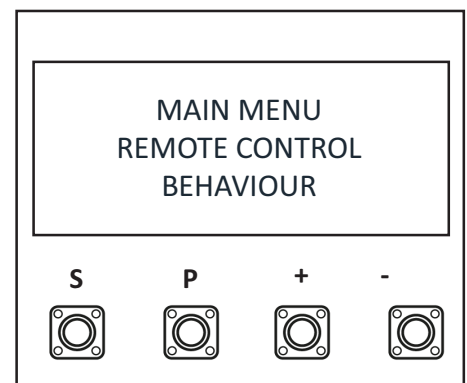

20 IR BEHAVIOUR

This option will program the direction the safety beams will monitor.

Default setting is to monitor in the CLOSE direction.

Press and hold the “P” Button to enter Program Mode.

Use the + or - button to navigate through the menu screen until you find MAIN MENU IR1-BEHAVIOUR”.

1. Press the “P” button to enter this setting (figure 1).
2. Press the “+” or “-” buttons to navigate through the options.
3. You can select the following options:
 - IR1-CLOSE DIR
 - IR1-OPEN DIR
 - IR1-OPEN & CLOSE DIR
 - IR1-CLOSE DIR + IMMEDIATE CLOSE

(When immediate close is selected. The gate will close 2s after the IRs are unblocked even if the TTC is set for longer then 2s). To confirm the setting, press the “P” button to save and return to the main menu screen.

NOTE: The above process is the same for IR2 & IR3 Behaviour.

figure 1

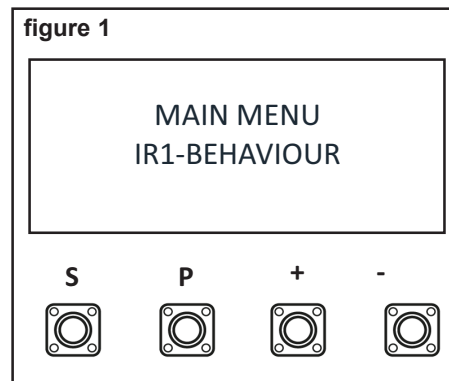

21 COMMAND INPUT

This option will program each Input Command (Input 1, Input 2, Input 3) independently and the gate behaviour when the Input is activated.

Default setting is to monitor in the OPEN/CLOSE direction.

Press and hold the “P” Button to enter Program Mode.

Use the + or - button to navigate through the menu screen until you find “MAIN MENU INPUT1”.

1. Press the “P” button to enter this setting (figure 1).
2. Press the “+” or “-” buttons to navigate through the options.
3. You can select the following options:
 - OPEN-CLOSE-OPEN
 - OPEN-STOP-CLOSE-STOP-OPEN
 - OPEN-STOP-CLOSE-OPEN
 - PEDESTRIAN OPENING
 - STOP
 - OPEN ONLY*
 - CLOSE ONLY
 - OPEN-STOP-OPEN-STOP
 - CLOSE-STOP-CLOSE-STOP
 - OPEN-HOLD TO RUN *
 - CLOSE-HOLD TO RUN
4. To confirm the setting, press the “P” button to save and return to the main menu screen.

NOTE: The above process is the same for Input Command for Input 2 & Input 3.

* If a latching toggle switch is used, this will override timer-to-close.

figure 1

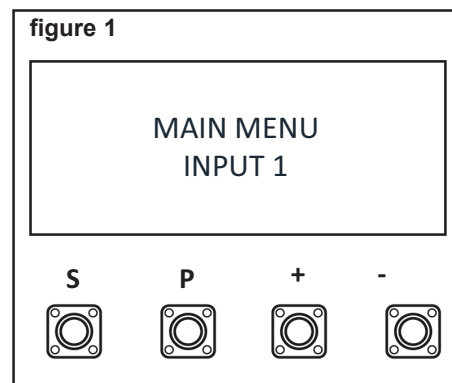

22 PEDESTRIAN COMMAND

This option will program the gate behaviour when a Pedestrian Mode activation is given via a remote control (See Transmitter Programming) or a Command Input. Default setting is to open 50% of the travel distance.

Press and hold the "P" Button to enter Program Mode.

Use the + or - button to navigate through the menu screen until you find "MAIN MENU PEDESTRIAN". Press the "P" button to enter this setting (figure 1).

1. Press the "P" button to enter this setting (figure 1).
2. Press the "+" or "-" buttons to navigate through the options.
3. You can select the following options:
 - 50 %openingtravel
 - 75% opening travel
 - Fully open
4. To confirm the setting, press the "P" button to save and return to the main menu screen.

figure 1

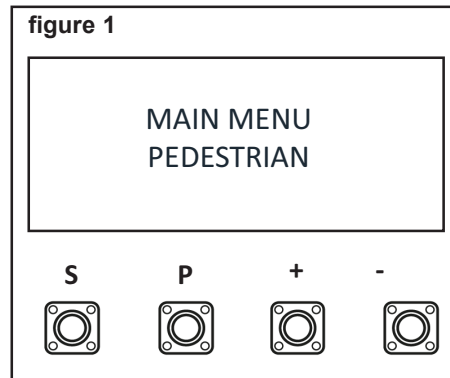

23 TIMER TO CLOSE (TTC)

This option will program the gate to close automatically after the programmed time. The timer will start the countdown from the fully open (or Pedestrian open) position. This option is only activated if IR beams are installed on IR1 and set to monitor in the close direction.

Press and hold the "P" Button to enter Program Mode.

Use the + or - button to navigate through the menu screen until you find "MAIN MENU TIMER-TO-CLOSE".

1. Press the "P" button to enter this setting (figure 1).
2. Press the "+" or "-" buttons to navigate through the options.
3. You can select the following options:
 - TTC Disabled
 - Setting TTC 10 Seconds
 - Setting TTC 20 Seconds
 - Setting TTC 30 Seconds
 - Setting TTC 45 Seconds
 - Setting TTC 1 Minute
 - Setting TTC 1.5 Minutes
 - Setting TTC 2 Minutes
 - Setting TTC 3 Minutes
 - Setting TTC 5 Minutes
4. To confirm the setting, press the "P" button to save and return to the main menu screen.

figure 1

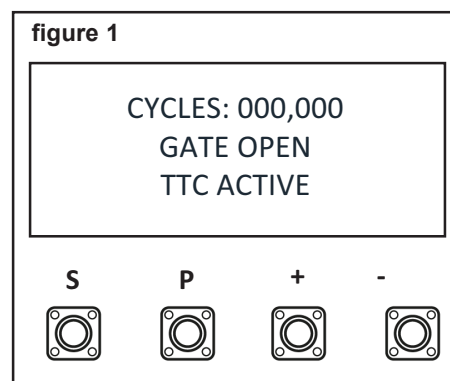

When TTC is enabled, during the countdown period, the screen displays as per figure.1.

24 REVERSAL TIME

This option will program the gate behaviour when during an obstruction (Force or IR).

Press and hold the "P" Button to enter Program Mode.

Use the + or - button to navigate through the menu screen until you find the menu screen until you find "MAIN MENU REVERSAL TIME". Press the "P" button to enter this setting (figure 1).

1. Press the "P" button to enter this setting (figure1).
2. Press the "+" or "-" buttons to navigate through the options.
3. You can select the following options:
 - 2 second reversal (both open and close direction)
 - Reverse to Limit (both open and close direction)
 - Close: Rev to Open Limit/ OPEN
4. To confirm the setting, press the "P" button to save and return to the main menu screen.

figure 1

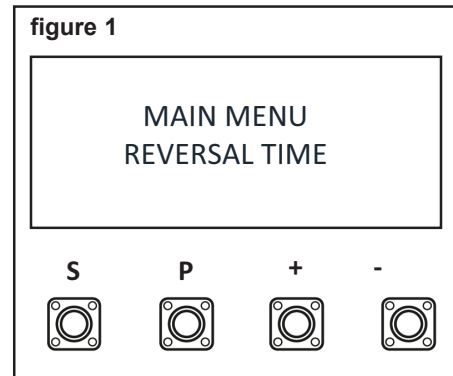

25 E-LOCK

NOTE: The E-LOCK default setting will be set to 5 seconds at the factory. When you plug the E-LOCK in it will work straight away.

This option will program the E-LOCK activation duration after the gate moves.

Press and hold the "P" Button to enter Program Mode.

Use the + or - button to navigate through the menu screen until you find the menu screen until you find "MAIN MENU E-LOCK".

1. Press the "P" button to enter this setting (figure 1).
2. Press the "+" or "-" buttons to navigate through the options.
3. You can select the following options:
 - Disabled
 - E-LOCK, 1 Second
 - E-LOCK, 2 Seconds
 - E-LOCK, 5 Seconds
 - Mag-Lock
4. To confirm the setting, press the "P" button to save and return to the main menu screen.

figure 1

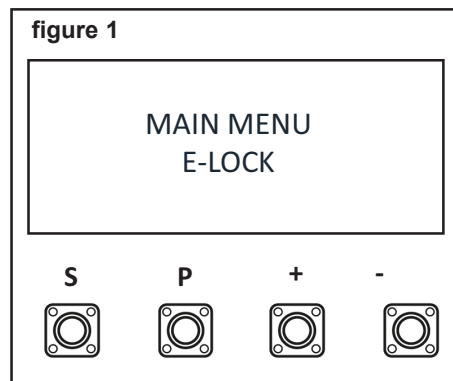

NOTE: The E-LOCK will activate 0.5 seconds prior to the opener moving, and remain activated for the duration selected.

26 RAM BLOW FOR E-LOCK

This option removes mechanical load on the E-LOCK allowing it to disengage freely. RAM BLOW will push the gate in the close direction for the programmed duration.

Press and hold the “P” Button to enter Program Mode.

Use the + or - button to navigate through the menu screen until you find the menu screen until you find “MAIN MENU RAM-BLOW”.

1. Press the “P” button to enter this setting (figure 1).
2. Press the “+” or “-” buttons to navigate through the options.
3. You can select the following options:
 - Disabled
 - RAM-BLOW 1 Second
 - RAM-BLOW 2 Seconds
4. To confirm the setting, press the “P” button to save and return to the main menu screen.

NOTE: This setting is only available if E-LOCK has been activated.

figure 1

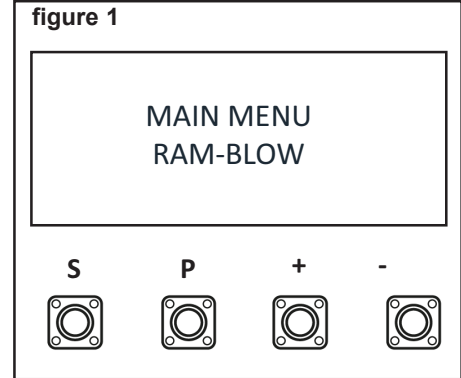

27 FLASHING LIGHT

This option will program the signal type for a flashing light (if connected).

Press and hold the “P” Button to enter Program Mode.

Use the + or - button to navigate through the menu screen until you find the menu screen until you find “MAIN MENU FLASHING LIGHT”.

1. Press the “P” button to enter this setting (figure 1).
2. Press the “+” or “-” buttons to navigate through the options.
3. You can select the following options:
 - Disabled
 - Continuous
 - Flashing
4. To confirm the setting, press the “P” button to save and return to the main menu screen.

figure 1

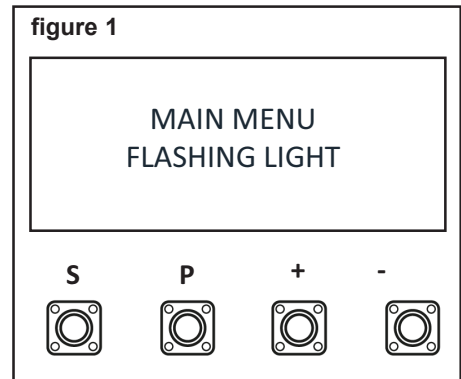

28 FLASHING LIGHT - PRE FLASHING

This option will program the flashing light (if connected) to flash for the programmed duration prior the gate moving.

Press and hold the “P” Button to enter Program Mode.

Use the + or - button to navigate through the menu screen until you find the menu screen until you find “MAIN MENU PRE FLASHING”.

1. Press the “P” button to enter this setting (figure 1).
2. Press the “+” or “-” buttons to navigate through the options.
3. You can select the following options:
 - Disabled
 - 1 Second
 - 2 Seconds
 - 3 Seconds
 - 4 Seconds
 - 5 Seconds
4. To confirm the setting, press the “P” button to save and return to the main menu screen.

figure 1

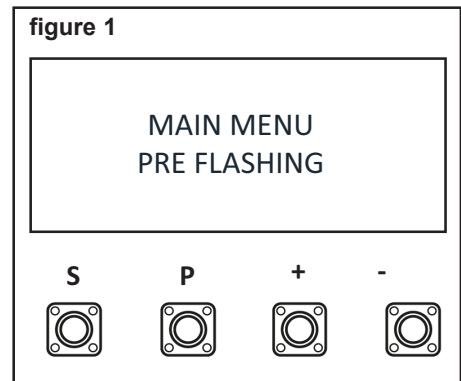

NOTE: This setting is only available if Flashing Light has been activated.

BASIC SETTINGS

29 SPECIAL CONTACT

This option will program the closed contact duration of the Special Contact relay. The relay will change state with each activation of the motor and remain closed for the programmed duration.

Press and hold the "P" Button to enter Program Mode.

Use the + or - button to navigate through the menu screen until you find the menu screen until you find "MAIN MENU SPECIAL CONTACT RELAY".

1. Press the "P" button to enter this setting (figure 1).
2. Press the "+" or "-" buttons to navigate through the options.
3. You can select the following options:
 - Disabled
 - 15 Seconds
 - 30 Seconds
 - 45 Seconds
 - 60 Seconds
 - 90 Seconds
 - 120 Seconds
 - 180 Seconds
 - 240 Seconds
 - 300 Seconds
4. To confirm the setting, press the "P" button to save and return to the main menu screen.

figure 1

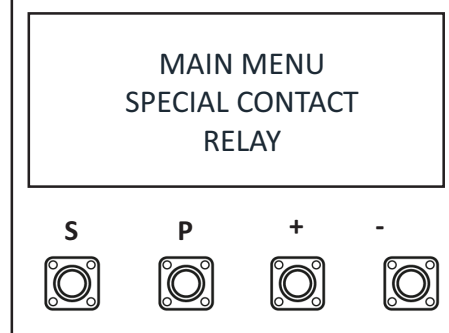

30 SOFT START DURATION IN OPEN AND CLOSE DIRECTION

This option will program the duration the gate drives from a limit at slow speed (Soft Start) Press and hold the "P" Button to enter Program Mode.

Use the + or - button to navigate through the menu screen until you find the menu screen until you find "MAIN MENU SOFT START DURATION SETTING".

1. Press the "P" button to enter this setting (figure 1).
2. Press the "+" or "-" buttons to navigate through the options.
3. You can select the following options:
 - Normal - 1 second duration (default)
 - Long - 2.5 seconds duration
 - Short - 0.5 second duration
4. To confirm the setting, press the "P" button to save and return to the main menu screen.

figure 1

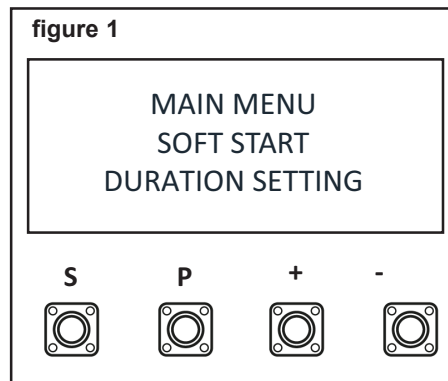

31 MAINTENANCE COUNTER

This option will program the number of cycles and enabling the Maintenance Counter. When the number of programmed cycles has been reached, a four second delay will be activated prior to the gate moving.

Press and hold the "P" Button to enter Program Mode.

Use the + or - button to navigate through the menu screen until you find the menu screen until you find "MAIN MENU MAINTENANCE COUNTER".

1. Press the "P" button to enter this setting (figure 1).
2. Press the "+" or "-" buttons to navigate options.
3. You can Disable the maintenance counter or select the maintenance counter to count from 1,000 cycles to 20,000 cycles.
4. To confirm the setting, press the "P" button to save and return to the main menu screen.

figure 1

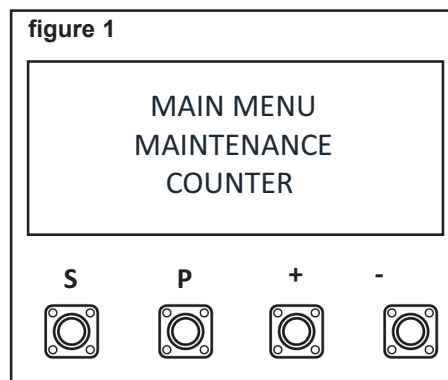

FACTORY RESET

32 FACTORY RESET

Within the Advance Setting, navigate through the menu screen until you find "MAIN MENU FACTORY RESET".

1. Press the "P" button to enter this setting (figure 1).
2. Press the "+" or "-" buttons to navigate through the options.
3. You can select the following options:
 - Execute Factory Reset
 - Exit
4. To confirm the setting, press the "P" button to save and return to the main menu screen.

NOTE: Deletes all settings. Does not delete remote controls and myQ devices.

figure 1

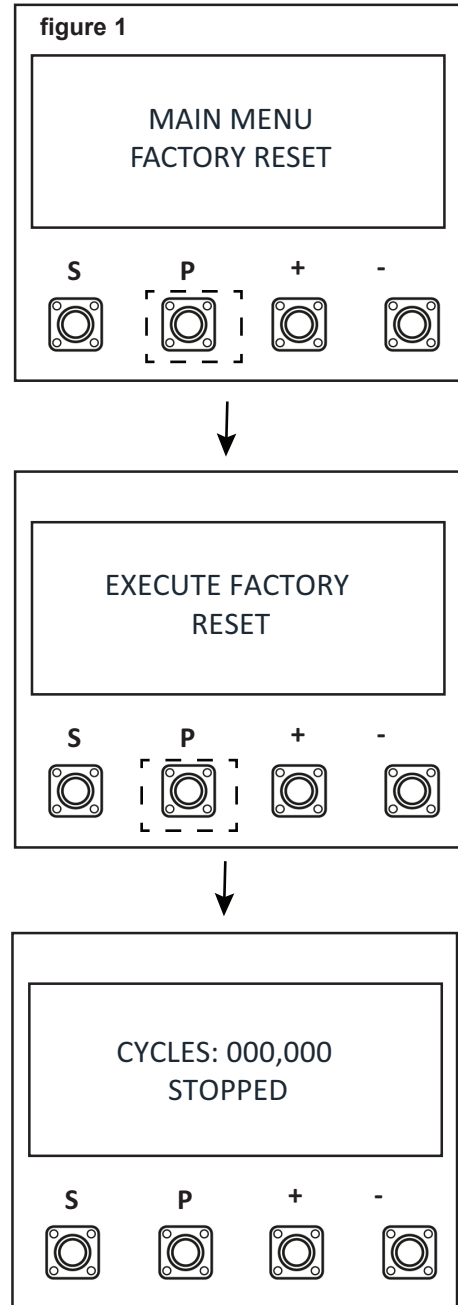

33 REMOTE CONTROL PROGRAMMING



Activate the opener only when the gate is in full view, free of obstruction and properly adjusted. Do not allow children to operate push button(s) or transmitter(s). Do not allow children to play near the gate.

NOTE: The transmitter(s) supplied with your opener are preprogrammed by the factory. If you purchase additional transmitters, the gate opener must be programmed to accept the new transmitter code.

Programming of Remote Controls

1. Press and hold the button on the hand-held transmitter or wall button that you wish to use.
2. Press and release the "S" button on the opener.
3. Release the remote control button after 3 seconds. It has learnt the code.
4. The screen will change to TRANSMITTER LEARNED before changing back to the STANDBY screen.

Now the opener will operate when the transmitter button is pressed.

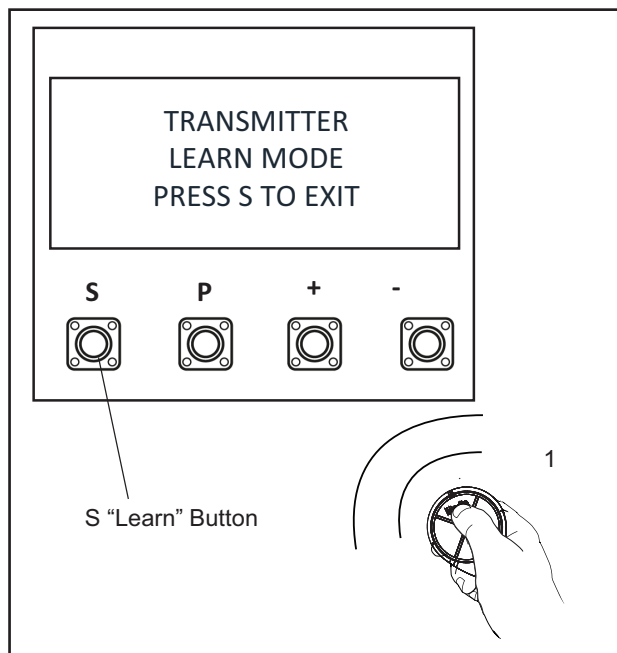

Programming of Remote Controls to activate Pedestrian mode

1. Press and Hold the button on the hand-held transmitter or wall button that you wish to use.
2. Press and release the "S" and "+" buttons simultaneously on the opener.
3. Release the remote control button after 3 seconds. It has learnt the code.
4. The screen will change to TRANSMITTER LEARNED (PED) before changing back to the STANDBY screen.

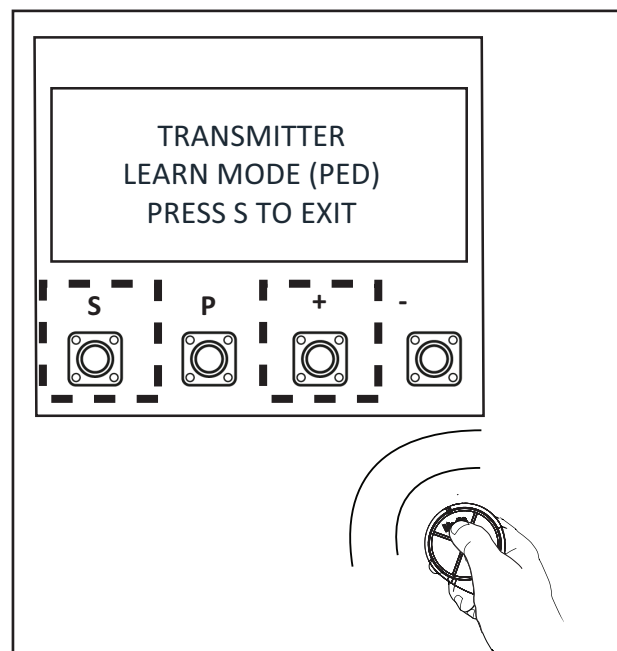

To Erase all Transmitter Codes

1. Press and hold the "S" button on the opener for approx. 6 seconds.
2. Release the button, all codes are now erased.
3. The screen will change to ALL TRANSMITTERS ERASED before changing back to the STANDBY screen.

34 MYQ SETUP – MYQ GATEWAY INSTALLATION (OPTIONAL)

The entire range of Merlin gate openers are myQ Capable and the below icon should be seen on the gate opener.



WARNING: Important Safety Instructions:

To prevent possible series injury/death, or property damage read and follow all instructions carefully.

The myQ® gateway is an accessory that can be purchased individually or as part of the myQ Connectivity Kit.

How To Connect The Merlin Gate Opener:

Scenario 1:

If the homeowner currently already has a Merlin gate opener or other device that is connected to the myQ App via a myQ® gateway accessory, the homeowner will need to:

- Purchase a Merlin gate opener that is myQ compatible (the latest range of Merlin gate openers are all myQ compatible)
- Ensure the Merlin gate opener is installed
- Purchase a set of the Protector System (Safety IR Beams) 772ANZ model or HPS15 Reflector Safety IR Beams
- Ensure the 772ANZ Protector System (Safety IR Beams) or HPS15 Reflector Safety IR Beams are installed
- Add the gate opener as an additional device to the myQ gateway through the myQ App.

Scenario 2:

If the homeowner doesn't have any myQ compatible products connected to the myQ App via a myQ® gateway accessory, the homeowner will need to:

- Purchase a Merlin gate opener that is myQ compatible (the latest range of Merlin gate openers are all myQ compatible)
- Ensure the Merlin gate opener is installed
- Purchase the gate myQ Connectivity Kit that includes 1 x myQ Gateway and 1 x 772ANZ or HPS15 Protector System (Safety IR Beams)
- Ensure the 772ANZ Protector System (Safety IR Beams) or HPS15 Reflector Safety IR Beams are installed
- Ensure the myQ Gateway is connected to the home internet router (refer to instructions on the next page)
- Create a myQ Account (if none exists) and sign into the myQ App
- Add the myQ Gateway to the myQ account in the myQ App
- Add the gate opener as an additional device to the myQ gateway through the myQ App (see page 26 for more details)

The myQ Gateway: is designed to operate with Merlin Gate openers and all the SAFETY INSTRUCTIONS detailed in this manual need to be observed.

Unattended Operation: The myQ Gateway allows operation of the gate via a smart phone, without visual monitoring. Never allow anyone to pass through, or leave obstacles in the area of a moving gate. Persons, pets and vehicles should remain clear until the gate has completely stopped.

Automatic Gate: The gate may operate unexpectedly, therefore do not allow anything to stay in the path of the gate.

The Protector System™ (Safety IR Beams) 772ANZ or HPS15 Reflector Safety IR Beams: For SAFE operation of the gate, the Protector System™ MUST BE INSTALLED and be fully functional. The gate will not operate if the Protector System™ is not functional.

34 MYQ SETUP – MYQ GATEWAY INSTALLATION (OPTIONAL) CONTINUED



WARNING: Important Safety Instructions:

Do not allow children to play near the gate, or with any gate controls, including remotes, Smartphones that has the myQ App installed.

INSTALLATION INSTRUCTIONS

A. Before You Begin

You must have – (check which scenario is relevant to this install and setup)

Scenario 1 (Already have a myQ device connected)

- A Merlin myQ compatible gate opener (All current Merlin gate openers are myQ compatible)
- The Protector System (Safety IR Beams) 772ANZ or HPS15 Reflector Safety IR Beams model

Scenario 2 (No myQ device connected)

- A Merlin myQ compatible gate opener (All current Merlin gate openers are myQ compatible)
- A router, with an active Broadband internet connection and a spare 10 Mbps Ethernet port
- myQ Gateway accessory 828AU model
- 5 VDC Power Pack (supplied with myQ Gateway)
- Ethernet Cable (supplied with myQ Gateway)
- The Protector System (Safety IR Beams) 772ANZ model or HPS15 Reflector Safety IR Beams model

B. Installation Process

- Gate Opener: Install the Merlin Gate Opener to a fully functional gate using the installation instructions included in this manual.
- Protector System (Safety IR Beams) 772ANZ or HPS15 Reflector Safety IR Beams:
Install the Protector System (Safety IR Beams) 772ANZ supplied with the gate myQ Connectivity Kit or as an individual accessory.

NOTE: The Protector System (Safety IR Beams) 772ANZ must be installed and operational for myQ to operate.

myQ Gateway

Connect the myQ Gateway by following the below steps.

Step 1 – Connect & Create

- Connect to the home internet router and power (figure 1)
- Download the free myQ App by visiting the App Store or Google Play Store
- You must have a valid email address to create a myQ account
Enter your information and click submit, an email will be sent to you to confirm your valid email address. If you do not get a confirming email, check your spam email folder or try creating the account again, being careful to spell the email address correctly
- When the myQ Gateway powers up, the GREEN LED and BLUE LED will blink 3 times to indicate a correct power connection and reset of the myQ Gateway. After power up, the LEDs will indicate the status of the myQ Gateway.
- If the GREEN LED is off after connecting the myQ Gateway to your router, check the Ethernet cable connection to your router. It must be in the LAN port, (normally numbered 1 – 4). If the GREEN LED is still off, try another port on your router. If you still cannot get a solid GREEN LED check your internet is ON, refer to gomerlin.com.au or gomerlin.co.nz. For further support contact Merlin Technical Support at customerservice@chamberlainanz.com.

figure 1

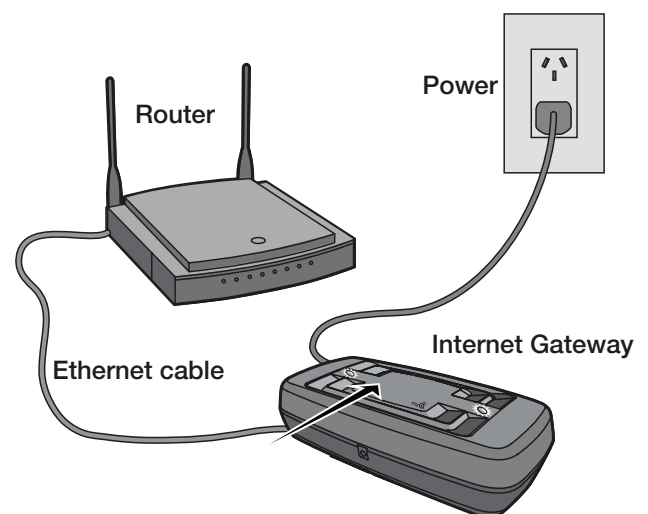

When the Internet Gateway connects to the Internet, the green LED will stop blinking and will remain on.

34 MYQ SETUP – MYQ GATEWAY INSTALLATION (OPTIONAL) CONTINUED

Step 2 – Register The myQ Gateway & Add Devices

Once you have successfully created your myQ® account, you must add the myQ® Gateway to the account. It is easy to do from your Internet enabled smartphone.

- To add the myQ® Gateway to your account, the GREEN LED on the myQ® Gateway must be on continuously. If the GREEN LED is not continuously on, see Step 1, Connect & Create. The myQ® Gateway must have an Internet connection for the phone to find it.
- Using the myQ® app, add the myQ® Gateway. Click on the plus symbol icon (bottom right corner), select “Device” then select “Internet Gateway” to add the myQ® Gateway.
- If this is the first myQ® Gateway connected to the account, the screen may already be at the step of “Register Gateway”. You will need the SERIAL NUMBER from the bottom label of the myQ® Gateway. The serial number is a series of ten characters, 0 – 9 or a – f. Be sure to use the correct characters (e.g., an eight “8” instead of an “B”) and keep the character spacing correct (XXXX-XXX-XXX).
- Name the myQ® Gateway (e.g., “123 Main Street” or “Home Sweet Home”). Click “Save and Close” to complete this step.
- You can add myQ® devices like the gate opener from the “Device Management” screen in the app. Under “HUBS”, select your Gateway, click “Add New” and select a device to add, then follow the steps to complete the set-up. Once you click NEXT you have 3 minutes to go to the gate opener and press it's learn button.
- The myQ® Gateway will pair to the opener. Once a device is programmed, it will appear on the screen. You can then name the device (e.g., front gate, etc.). The Blue LED light on the Gateway indicates an opener is paired to the Gateway.

For Troubleshooting, Diagnostics and other information, scan the below QR code:

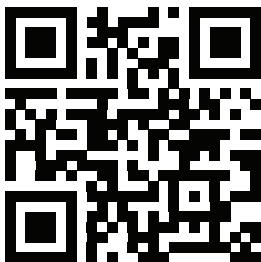

iPhone® is a registered trademark of Apple Inc

Android™ is a registered trademark of Google Inc.

35 DIAGNOSTICS



To reduce the risk of **SEVERE INJURY** or **DEATH**:

- Disconnect **ALL** power **BEFORE** performing **ANY** maintenance.
- **ALL** maintenance **MUST** be performed by a professional installer.
- **ALWAYS** wear protective gloves and eye protection when changing the battery.
- If the supply cord is damaged, it **MUST** be replaced by the manufacturer, its service agent or similarly qualified persons in order to avoid hazard.

Error	Problem	Action Required	How to Clear
ERR: IR1 ERR: IR2 ERR: IR3	<ul style="list-style-type: none"> • IR# is not connected, or open circuit • IR# wire has a short circuit • IR# is connected reverse polarity • IR# is not aligned correctly • IR# is sensing an obstruction 	<ul style="list-style-type: none"> • Check the Protector System has been installed and connected correctly. • Check the cables for any breaks or damage. • Check for a short between the IR terminals • Check polarity of the installed Protector System • Check for incorrect accessories wired into the IR terminals. • Check the Protector System for alignment or an obstruction. 	<ul style="list-style-type: none"> • Auto reset once obstruction is clear or Protector System is realigned. (may take up to 16 seconds)
ERR: SAFETY EDGE	<ul style="list-style-type: none"> • The Safety Edge is not connected • The Safety Edge is not connected with an 8.2KΩ resistor • The Safety Edge has a short circuit • The Safety Edge being pressed 	<ul style="list-style-type: none"> • Check the Safety Edge has been installed and connected correctly. • Check the 8.2KΩ resistor is connected. • Check for a short in the cabling • Check for incorrect accessories wired into the Safety Edge terminals. • Check the Safety Edge is not being pressed. 	<ul style="list-style-type: none"> • Auto reset once Safety Edge is not pressed (may take up to 16 seconds)
ERR: STOP INPUT	<ul style="list-style-type: none"> • STOP switch is open • STOP Switch is not connected 	<ul style="list-style-type: none"> • Check if the STOP switch is open circuit or damaged. • Check if the STOP switch has been disconnected. If so, reconnect, or install a small loop wire to replace the STOP switch closed contact. 	<ul style="list-style-type: none"> • Auto reset once the issue has been resolved. (may take up to 16 seconds)

OPERATION AND MAINTENANCE

35 DIAGNOSTICS

Error	Problem	Action Required	How to Clear
ERR: MOTOR1 ERR: MOTOR1	<ul style="list-style-type: none"> PCB has detected a motor failure 	<ul style="list-style-type: none"> Power down the gate operator for 20 seconds. Once the gate has been powered up again, check if the PCB has reset. If not, change the PCB. 	<ul style="list-style-type: none"> Power down for 20 seconds and power on to reset.
ERR: PCB	<ul style="list-style-type: none"> PCB memory failure 	<ul style="list-style-type: none"> Power down the gate operator for 20 seconds. Once the gate has been powered up again, check if the PCB has reset. If not, change the PCB. 	<ul style="list-style-type: none"> Power down for 20 seconds and power on to reset.
ERR: OBSTR. MOT1	<ul style="list-style-type: none"> Motor # is blocked and unable to move 	<ul style="list-style-type: none"> Check the motor is free to move. Clear any obstruction. Check any pivot points or track for debris jamming the motor or gate. 	<ul style="list-style-type: none"> Auto reset once the issue has been resolved. (may take up to 16 seconds)
ERR: MOTOR1 RPM	<ul style="list-style-type: none"> Motor # is stalled or RPM is damaged 	<ul style="list-style-type: none"> Check if the motor is stalled or RPM is damaged 	<ul style="list-style-type: none"> Auto reset once the issue has been resolved. (may take up to 16 seconds)
ERR: RADIO	<ul style="list-style-type: none"> Radio module failure 	<ul style="list-style-type: none"> Power down the gate operator for 20 seconds. Once the gate has been powered up again, check if the PCB has reset. If not, change the PCB. 	<ul style="list-style-type: none"> Power down for 20 seconds and power on to reset.
ERR: BATTERY	<ul style="list-style-type: none"> Battery Voltage is low 	<ul style="list-style-type: none"> Check the battery voltage Charge battery 	<ul style="list-style-type: none"> Auto reset once the issue has been resolved. (may take up to 16 seconds)
ERR: SYNC	<ul style="list-style-type: none"> SYNC connector is short circuited 	<ul style="list-style-type: none"> Check if the SYNC connector is short circuited. 	<ul style="list-style-type: none"> Auto reset once the issue has been resolved. (may take up to 16 seconds)
ERR: LIMITS	<ul style="list-style-type: none"> Incorrectly pressing 'P' during limit learning 	<ul style="list-style-type: none"> Relearn limits Reset basic Settings 	<ul style="list-style-type: none"> Relearn limits Complete Basic Settings if required.

OPERATION AND MAINTENANCE

36 ACCESSORIES

1. E148M	4 Channel Wireless wall button	11. MGBBU	Battery Backup (not shown)
2. E985M	4 Channel transmitter	12. 921GA-CP4	Loop Detector (not shown)
3. E975M	4 Channel transmitter	13. ELOCK-R	E-LOCK (not shown)*
4. E960M	4 Channel transmitter	14. MG-485AU	Maglock (not shown)
5. E964M	4 Channel visor transmitter	15. CP4	Vehicle Sensing Probe (not shown)
6. E840M	Keyless entry system	16. 002A2331	6 Pin Wire Harness (not shown)
7. E850M	Wireless Keypad	17. Model GWS-L24X	Flashing Lamps (not shown)
8. 772ANZ	The Protector System™	18. Model GWS-S24	Sounders (not shown)
9. HPS15	Reflector Safety Beams	19. PU100	Emergency Stop Switch (not shown)
10. BOLLARD-SNGL-R		20. AT000	Timer (24h) (not shown)

*** NOTE - The E-LOCK for Rural Gates (ELOCK-R) does not function when the Swing LR 500 gate opener is powered by the optional Battery Backup (MGBBU). Manual release of the lock is required to open the gate if operated under Battery Backup power.**

Alternative E-LOCKS which operate under Battery Backup Power: ELOCK-H (E-LOCK for Horizontal Installation) and ELOCK-V (E-LOCK for Vertical Installation).

E148M

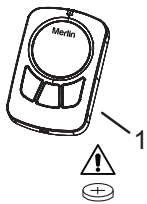

E985M

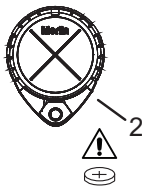

E975M

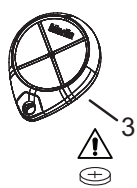

E960M

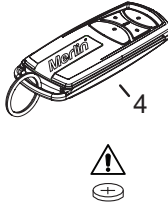

E964M

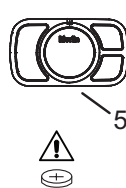

E840M

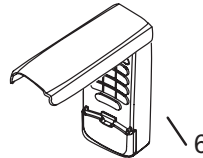

BOLLARD-SNGL-R

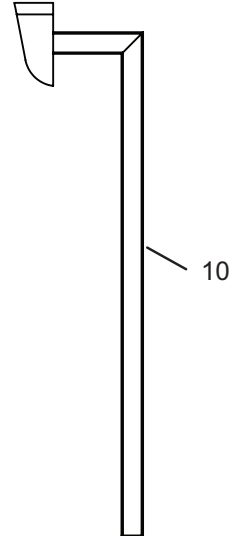

E850M

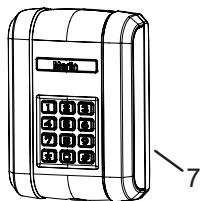

772ANZ

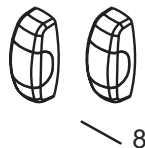

HPS15

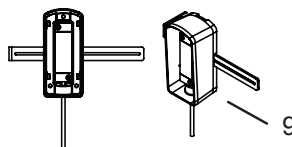

WARNING! This product contains a button/coin cell battery.

- The battery is hazardous.
- Keep new and used batteries away from children.
- Do not ingest battery. Chemical burn hazard.
- If the coin cell battery is swallowed or placed inside any part of the body, it can cause severe or fatal injuries in 2 hours or less.
- If the battery compartment does not close securely, stop using the product and keep away from children.
- If you think batteries might have been swallowed or placed inside any part of the body, call the 24-hour Poisons Information Centre on 13 11 26 in Australia, or the 24-hour National Poisons Centre on 0800 764 766 in New Zealand, or seek immediate medical attention.
- Dispose of used coin/button cell batteries immediately and safely. Flat batteries can still be dangerous.

PROGRAMMING FLOW CHART

37 BASIC SETTINGS - PART 1

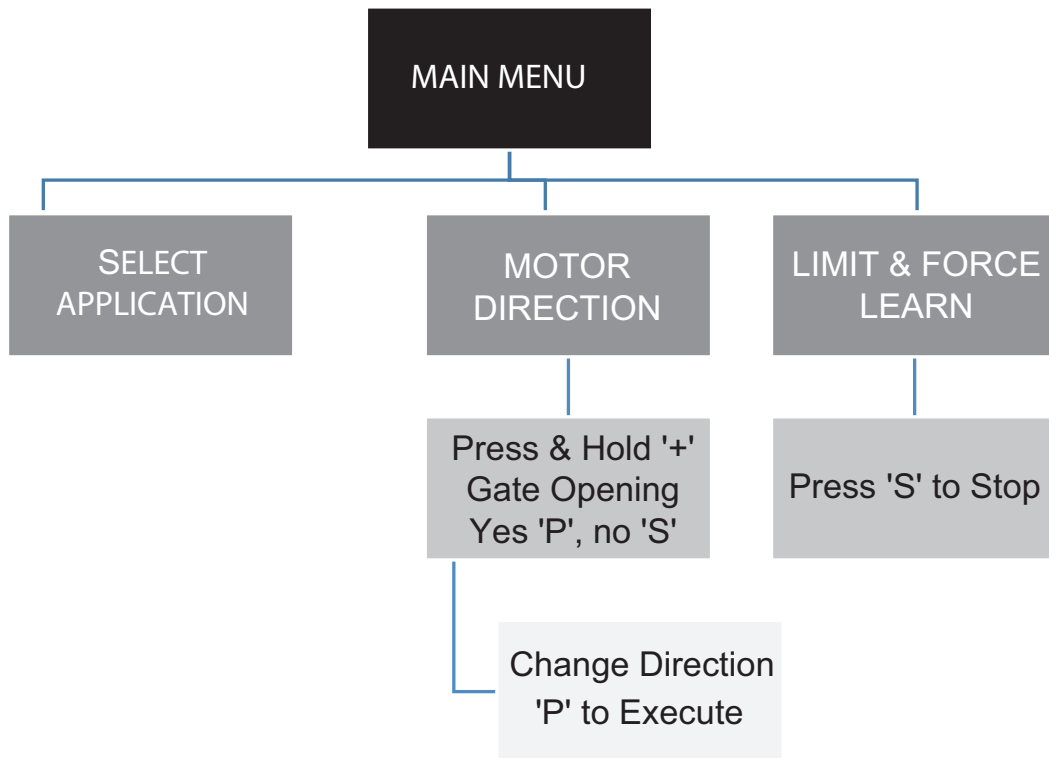

PROGRAMMING FLOW CHART

37 BASIC SETTINGS - PART 2

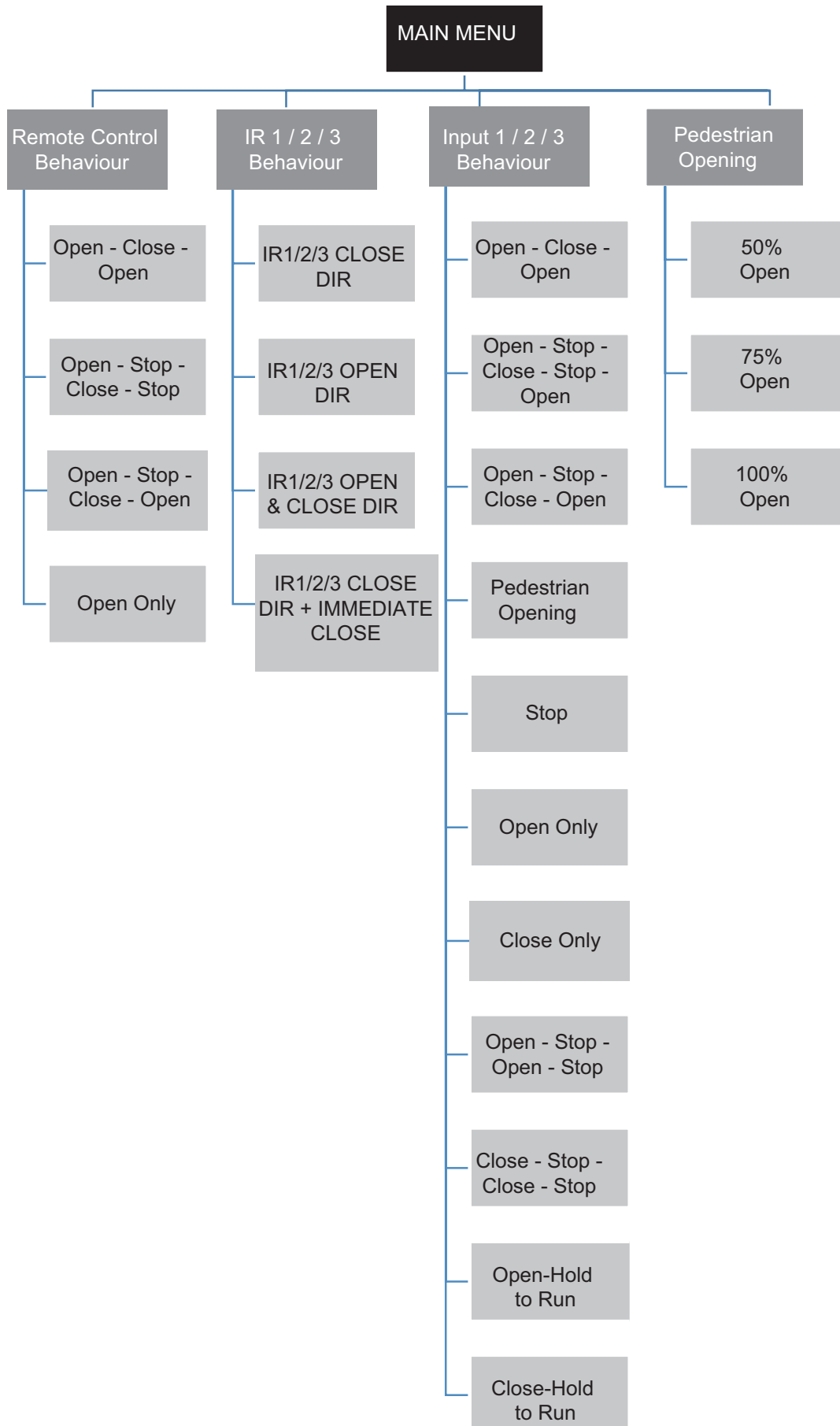

PROGRAMMING FLOW CHART

37 BASIC SETTINGS - PART 3

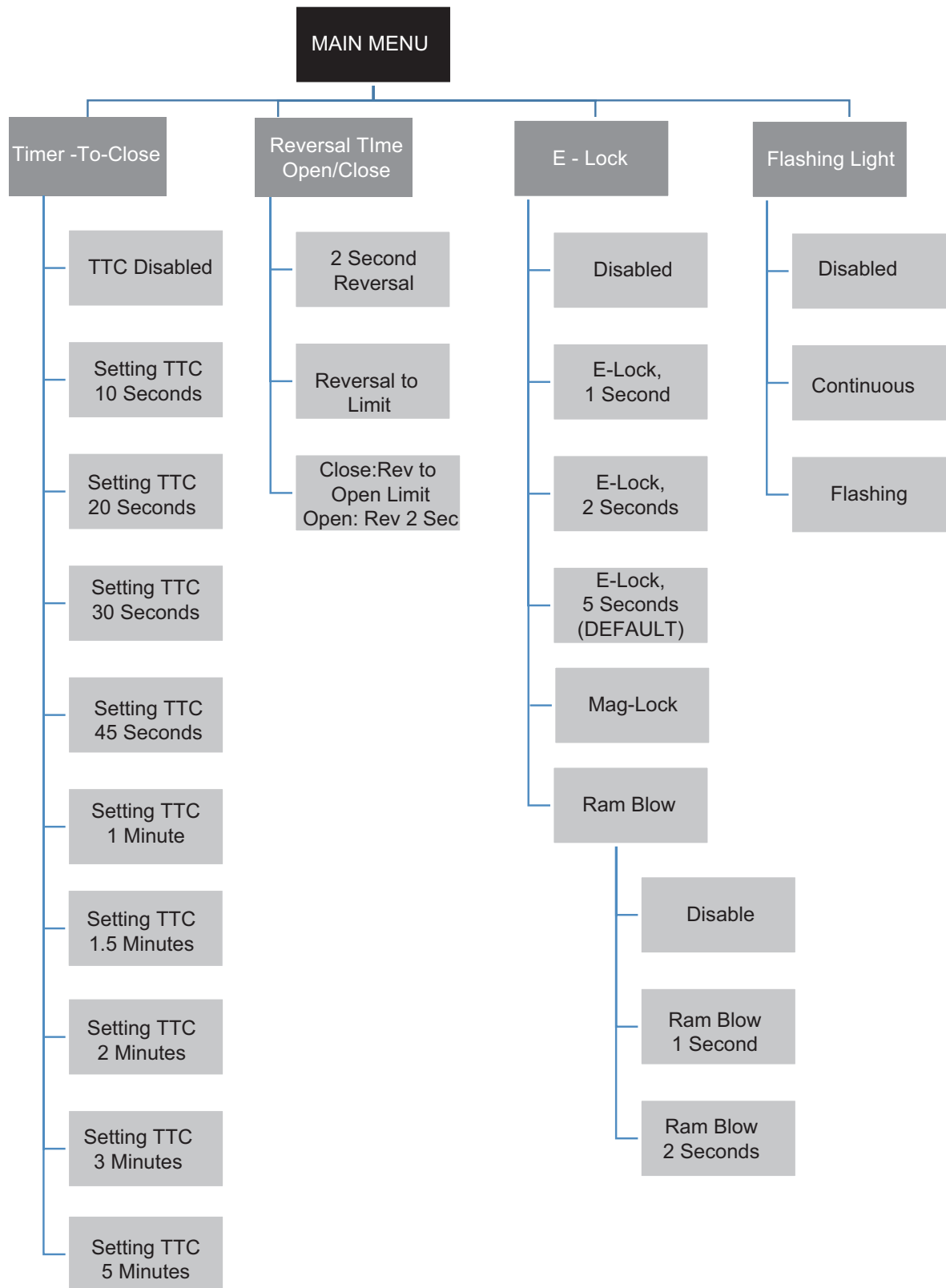

PROGRAMMING FLOW CHART

37 BASIC SETTINGS - PART 4

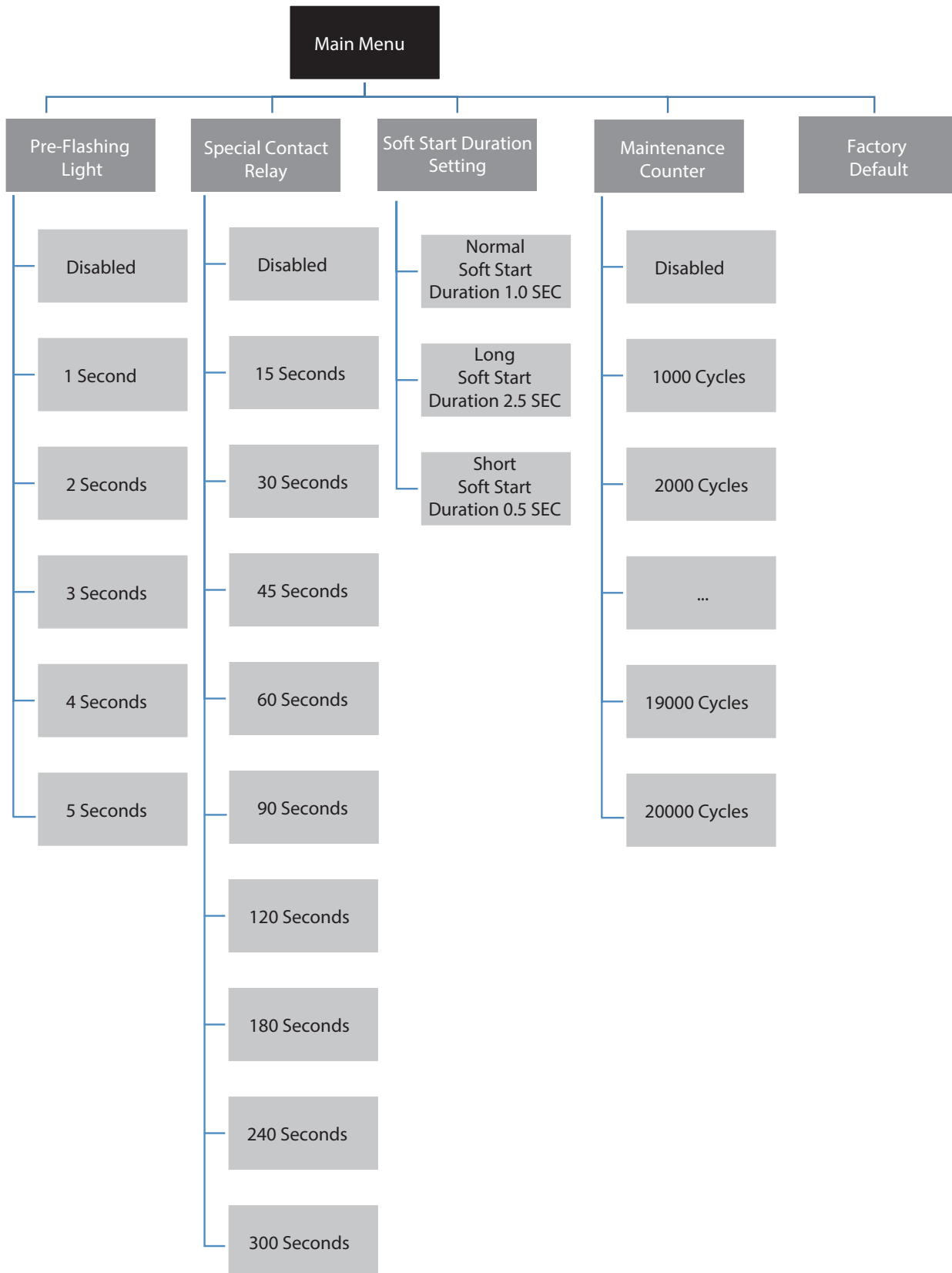

DON'T FORGET

Warranty Registration

To validate your warranty you must
complete the registration form online at:

gomerlin.com.au/warranty
or
gomerlin.co.nz/warranty

Merlin[®]
Powering Garage Doors

Get Connected with



Additional purchase of the myQ Connectivity Kit is required
to enable myQ functionality.

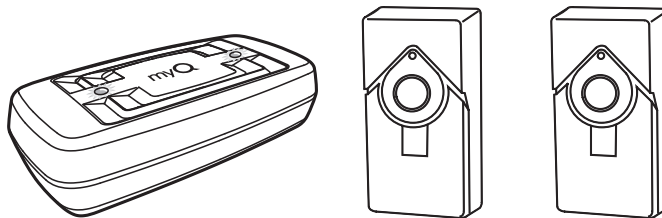

Visit www.gomerlin.com.au or
www.gomerlin.co.nz
for more details.



WARRANTY

Limited Warranty in Australia and New Zealand

Merlin® Swing LR 500

Swing Gate Opener

1 Your consumer rights and guarantees

This Limited Warranty is provided by Chamberlain Australia Pty Ltd, Chamberlain New Zealand Limited (**Chamberlain**), contact details in Section 5 below. This Limited Warranty applies to the Merlin® Swing LR 500 unit (**Unit**) purchased in Australia and New Zealand, and gives you benefits which are in addition to your consumer rights and remedies under the Australian Consumer Law (or corresponding New Zealand consumer protection laws).

You can find out more information about your consumer rights and guarantees which the law provides in Australia at www.accc.gov.au, in New Zealand at www.consumerprotection.govt.nz. We also provide this statement as required under the Australian Consumer Law:

Our goods come with guarantees that cannot be excluded under the Australian Consumer Law. You are entitled to a replacement or refund for a major failure and for compensation for any other reasonably foreseeable loss or damage. You are also entitled to have the goods repaired or replaced if the goods fail to be of acceptable quality and the failure does not amount to a major failure.

2 What does our Limited Warranty cover?

Chamberlain warrants that, when purchased new in Australia or New Zealand, the Unit (all parts of the Unit other than globes and batteries) is free from defects in materials and workmanship (**Limited Warranty**) for the Limited Warranty period, subject to the terms and conditions of this Limited Warranty.

The Limited Warranty period (for Accessories see below) is 3 years (36 months) or 150,000 cycles (each opening and closing of the gate equals 1 cycle) whichever comes first, from the date of purchase of the Unit when installed by a Professional Dealer authorised by Chamberlain on a typical gate installation designed for non-commercial application, within the indicated specifications.

The Limited Warranty period for remote controlled transmitters and accessories included with the Unit (**Accessories**) is 12 months from the date of purchase.

3 Limited Warranty Conditions

The following terms and conditions apply to your Limited Warranty:

- our Limited Warranty is effective from date of purchase as indicated in Section 2 above;
- proof of purchase of the Unit is required;
- purchaser must ensure the gate is professionally maintained and serviced by a Professional Dealer during the Chamberlain Limited Warranty period such that the gate operates according to manufacturer specifications. If your gate binds or sticks, then it must not be used until serviced by a trained gate technician or authorised dealer. The gate service fee will be at the purchaser's expense;

Please also see the User Manual for the Unit available on our website, or provided at the time of purchase.

4 What is not covered

• Batteries and globes are not covered under the Chamberlain Limited Warranty.

• Travel costs incurred by Chamberlain or its authorised dealer and or trained gate technician in either travelling to and from areas outside a capital city area. These costs will be at the purchaser's expense.

• Additional access costs incurred by Chamberlain or its authorised dealer and or a trained gate technician in obtaining access to premises where the Unit is not readily accessible. These costs will be at the purchaser's expense.

Our Limited Warranty covers defects as explained, and does not cover all problems and mishaps that may occur in relation to the Unit including:

- you got what you asked for but simply changed your mind, found it cheaper somewhere else, decided you did not like the purchase or had no use for it;
- you misused the Unit in any way that caused the problem;
- you knew of or were made aware of any deficiencies with the Unit before date of purchase;
- use of the Unit with controls or third party devices or software which has not been supplied, or pre-approved, by Chamberlain;
- problems relating to or residing in third party hardware, software or other items with which our product is used;
- any loss of data related to you or provided by you, or loss related to downtime associated with use of the product, whether through power outage, failure of internet or wireless connectivity, network disruptions, or otherwise;
- non-compliance with the relevant instructions in the User Manual;

- tampering, neglect, abuse, wear and tear, accident, electrical storm, excessive use or conditions other than normal use;
- problems with, or relating to, the gate hardware, including but not limited to the springs, gate alignment, hinges, guides;
- problems caused by electrical faults or replacement of batteries or light bulbs, blown fuses, electrical surges, power surges or power strikes, fire, flood, rain, water, lightning or storms;
- water or moisture ingress that causes corrosion or electrical malfunction;
- corrosion caused by sea air if located near a waterway, beach etc;
- fitment to a commercial gate or in a commercial operating application, installation of a residential gate opener in a commercial or industrial premises;
- lack of proper maintenance, service or care of the gate and/or Unit; and/or
- damage caused by insects, pests or other after sale damage caused by events or accidents outside Chamberlain's reasonable control and not arising under normal and standard operating conditions.

5 Where you need help with our product

If you have a problem with the Unit or if you are concerned it may be defective, please contact our Customer Service team below:

Australia	Phone toll free 1800 638 234
Fax toll free	1800 888 121
Address	Unit 1, 75 Epping Road North Ryde, NSW 2113
Email	customerservice@chamberlainnz.com
Website	www.gomerlin.com.au
New Zealand	Phone toll free 0800 653 667
Auckland	phone 09 477 2823
Fax toll free	0800 653 663
Email	customerservice@chamberlainnz.com
Website	www.gomerlin.co.nz

As a first step, our Customer Service team will provide product support assistance to help you try to resolve the problem and in some cases, replacement parts for "do it yourself repairs". If our technical team need to see the product to determine the nature of the fault, we will arrange an inspection by an trained gate technician, or ask that you send the product to us.

If your product was installed at your premises by an authorised dealer, please contact the installer indicated in your sales documents for prompt on-site service, or consult our Customer Service team if you need help in finding a local service technician. A service fee for on-site service may apply.

Authorisation from Chamberlain is required for warranty service under this Limited Warranty.

6 Delivery Charges

If an inspection is required in order to determine the nature of the fault, please send the Unit freight paid and well packaged in accordance with our instructions. Any costs associated with transporting the Unit will be at Chamberlain's cost if the Unit has breached a statutory consumer guarantee. Repairs and replacement parts provided under this Limited Warranty are free of charge (and repaired items or replacement parts for Units found to be defective will be returned to you at our cost), and warranted by Chamberlain for the remaining portion of the original warranty period. However, if you make a claim under this Limited Warranty, and this Limited Warranty does not apply, or if the law does not provide you with a statutory right or remedy as a consumer, you may be required to pay labour, assessment and/or freight costs and delivery charges to repair, replace and/or return the Unit to you.

7 How to register your product

Please register your Unit and contact details at this link www.gomerlin.com.au/warranty-registration/ for Australia, or www.gomerlin.co.nz/register-your-warranty/ for New Zealand, so that we or your authorised installer can locate your details and provide you with product support assistance as quickly as possible, and keep you up to date with product updates. Registration can also be done by contacting Chamberlain Customer Service.

8 Important Reminder

All other guarantees (other than your statutory rights and guarantees as a consumer under applicable laws) are excluded to the fullest extent that we may lawfully do so. Unless the law requires us to do so, we do not accept any other liability, such as compensation for damages, injury or loss.

Last updated: 27th May 2025