

# REMOTE PRO

## PROGRAMMING INSTRUCTIONS



### Programming your remote to TMT Sectional Garage Door openers

(※ JASPER & BASALT Series)

1. Press “RF” button (as Picture ①) for 3 seconds
2. LED Display shows “CS” (as Picture ②)

picture ①

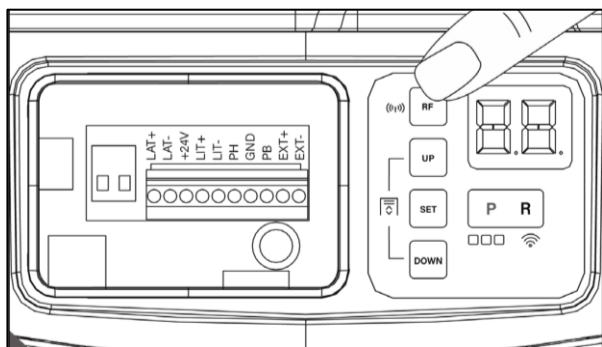

picture ②

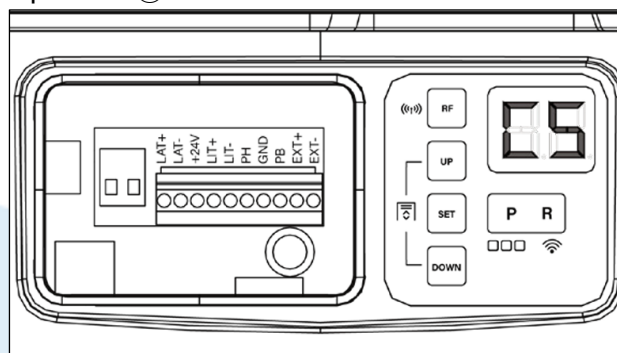

3. After seen “CS”, then press remote controller’s “A or ○” button (as Picture ③)

picture ③

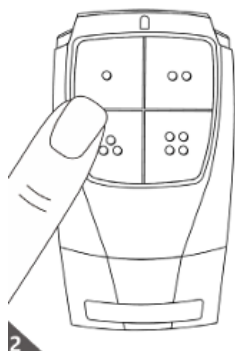

4. “CS” in LED Display will blink three times then keep shows “CS”  
(While “CS” is on, you can programme another remote controllers and wall mounted switch)
5. Please wait for 10 seconds until “CS” on LED Display will be disappeared.

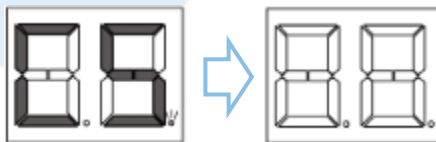

6. “CS” on LED Display is disappeared, then the remote controller programming process is completed.

### Cloning Remote Controllers & Wall Mounted Switch

(※ Sectional & Roller Garage Door openers only)



1. Press “A” & “B” buttons together for 5 seconds
2. “Beep” sound for seconds & motor LED Light is flashing for 10sec.
3. While motor LED Light flashing, then follow from step 3 above  
→ Press remote controller “A or ○” button (as Picture ③)  
(While “CS” is on, you can programme another remote controllers and wall mounted switch)

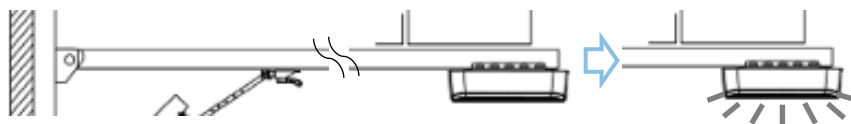

Flashing LED Light

#### WARNING

This product may contain a coin/button cell battery. Keep product and batteries away from children. A battery can cause severe or fatal injuries in 2 hours or less if swallowed or placed inside any part of the body. Seek immediate medical attention if it is suspected that a coin/button cell battery has been swallowed or placed inside of any part of the body.



# REMOTE PRO

## PROGRAMMING INSTRUCTIONS



### Programming your remote to TMT Sectional Garage Door openers

(※ COBBLE Series)

1. Press “RF” button (as Picture ①) for 3 seconds
2. LED Display shows “CS” (as Picture ②)

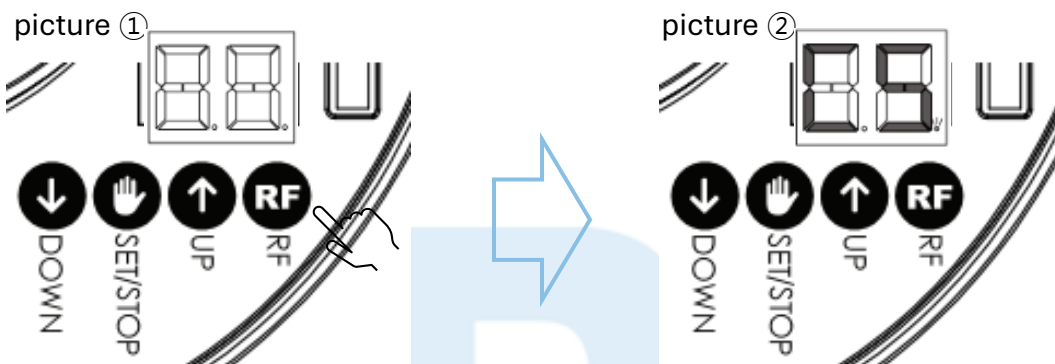

3. After seen “CS”, then press remote controller’s “A or ○” button (as Picture ③)

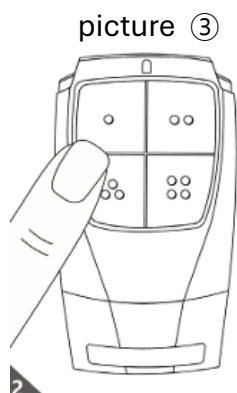

4. “CS” in LED Display will blink three times then keep shows “CS”  
(While “CS” is on, you can programme another remote controllers and wall mounted switch)
5. Please wait for 10 seconds until “CS” on LED Display will be disappeared.

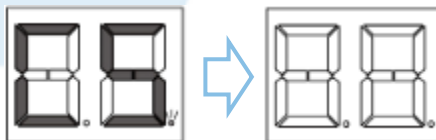

6. “CS” on LED Display is disappeared, then the remote controller programming process is completed.

### Cloning Remote Controllers & Wall Mounted Switch

(※ Sectional & Roller Garage Door openers only)



1. Press “A” & “B” buttons together for 5 seconds
2. “Beep” sound for seconds & motor LED Light is flashing for 10sec.
3. While motor LED Light flashing, then follow from step 3 above  
→ Press remote controller “A or ○” button (as Picture ③)  
(While “CS” is on, you can programme another remote controllers and wall mounted switch)

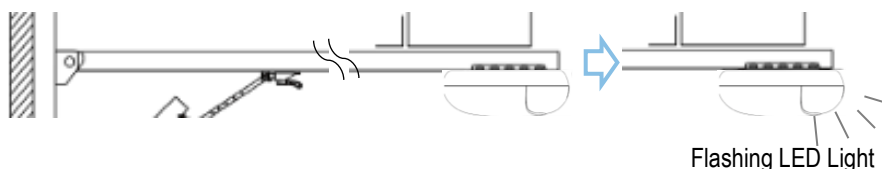

#### WARNING

This product may contain a coin/button cell battery. Keep product and batteries away from children. A battery can cause severe or fatal injuries in 2 hours or less if swallowed or placed inside any part of the body. Seek immediate medical attention if it is suspected that a coin/button cell battery has been swallowed or placed inside of any part of the body.



# REMOTE PRO

## PROGRAMMING INSTRUCTIONS



### Programming your remote to TMT Sectional Garage Door openers

(※ MAX 650)

1. Press “RF” button (as Picture ①) for 3 seconds
2. LED Display shows “CS” (as Picture ②)

picture ①



picture ②



3. After seen “CS”, then press remote controller’s “A or ○” button (as Picture ③)

picture ③

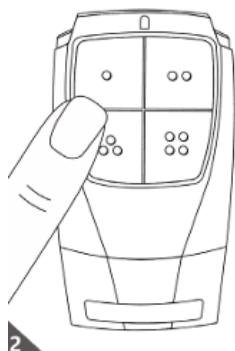

4. “CS” in LED Display will blink three times then keep shows “CS”  
(While “CS” is on, you can programme another remote controllers and wall mounted switch)
5. Please wait for 10 seconds until “CS” on LED Display will be disappeared.

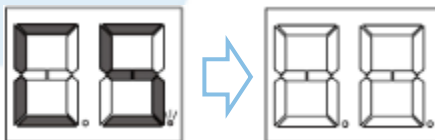

6. “CS” on LED Display is disappeared, then the remote controller programming process is completed.

### Cloning Remote Controllers & Wall Mounted Switch

(※ Sectional & Roller Garage Door openers only)



1. Press “A” & “B” buttons together for 5 seconds
2. “Beep” sound for seconds & motor LED Light is flashing for 10sec.
3. While motor LED Light flashing, then follow from step 3 above  
→ Press remote controller “A or ○” button (as Picture ③)  
(While “CS” is on, you can programme another remote controllers and wall mounted switch)

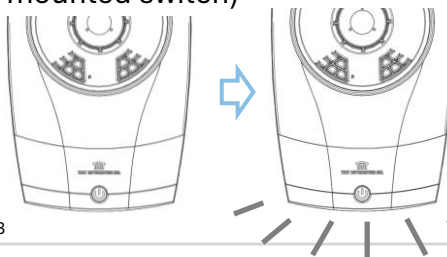

Flashing LED Light

#### WARNING

This product may contain a coin/button cell battery. Keep product and batteries away from children. A battery can cause severe or fatal injuries in 2 hours or less if swallowed or placed inside any part of the body. Seek immediate medical attention if it is suspected that a coin/button cell battery has been swallowed or placed inside of any part of the body.



### Programming your remote to TMT Sectional Garage Door openers

(※ CB19 & PAPILLON 250 & BOXER Series)

1. Press “RF” button (as Picture ①) for 3 seconds
2. LED Display shows “CS” (as Picture ②)

picture ①

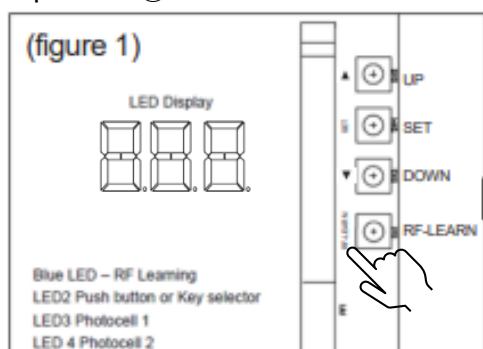

picture ②

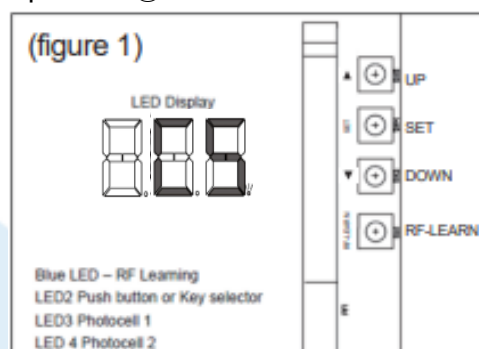

3. After seen “CS”, then press remote controller’s “A or ○” button (as Picture ③)

picture ③

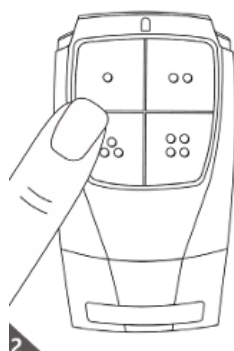

4. “CS” in LED Display will blink three times then keep shows “CS” (While “CS” is on, you can programme another remote controllers and wall mounted switch)
5. Please wait for 10 seconds until “CS” on LED Display will be disappeared.

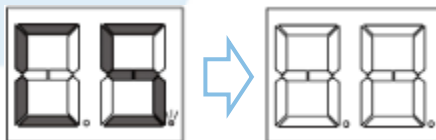

6. “CS” on LED Display is disappeared, then the remote controller programming process is completed.

#### WARNING

This product may contain a coin/button cell battery. Keep product and batteries away from children. A battery can cause severe or fatal injuries in 2 hours or less if swallowed or placed inside any part of the body. Seek immediate medical attention if it is suspected that a coin/button cell battery has been swallowed or placed inside of any part of the body.

